

CITY OF GUELPH

ROAD ALLOWANCE ALONG THE BOUNDARY BETWEEN THE GEOGRAPHIC TOWNSHIPS OF GUELPH & PUSLINCH - AKA STONE ROAD EAST (WIDTH VARIES)

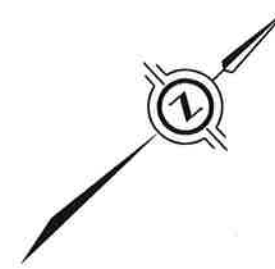

PLAN

PREPARED FOR MINOR VARIANCE / LOT LINE ADJUSTMENT APPLICATION

SCALE 1 : 1000



METRIC: DISTANCES SHOWN ON THIS PLAN ARE IN METRES AND CAN BE CONVERTED TO FEET BY DIVIDING BY 0.3048
CAUTION: THIS IS NOT A PLAN OF SURVEY AND SHALL NOT BE USED EXCEPT FOR THE PURPOSE INDICATED IN THE TITLE BLOCK.

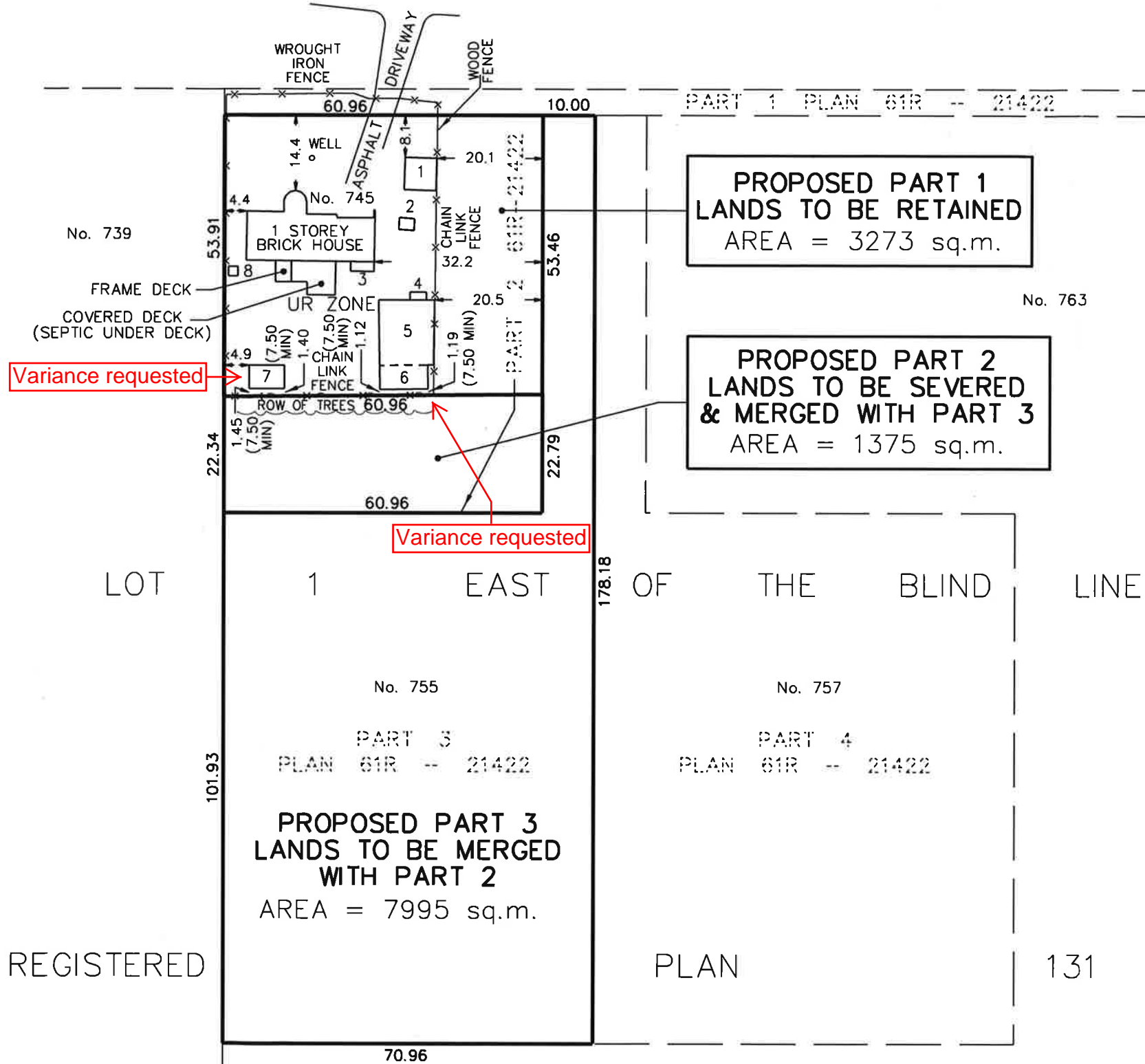

ACCESSORY BUILDING SCHEDULE

- 1 - 1 STOREY METAL CLAD GARAGE (37.9 sq.m.)
- 2 - METAL CLAD SHED (6.8 sq.m.)
- 3 - VINYL CLAD SHED (8.4 sq.m.)
- 4 - METAL CLAD SHED (4.7 sq.m.)
- 5 - 2 STOREY METAL CLAD BUILDING (136.5 sq.m.)
- 6 - 1 STOREY PORTION (42.7 sq.m.)
- 7 - 1 STOREY METAL CLAD BUILDING (30.4 sq.m.)
- 8 - METAL CLAD SHED (3.3 sq.m.)

(TOTAL = 270.7 sq.m.
 - PROPOSED COVERAGE = 8%)

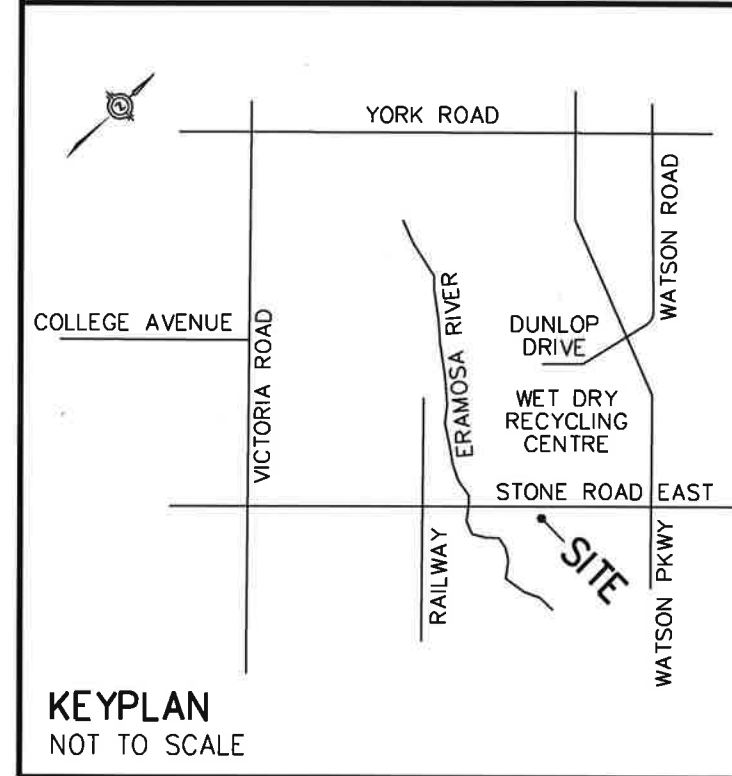

KEYPLAN
NOT TO SCALE

NOTES

THE FIELD SURVEY PORTION OF THIS PLAN WAS COMPLETED ON MARCH 16, 2021.

REVISIONS			
NO.	DATE	BY	DESCRIPTION
1.			
2.			

FILE: G:\21-14-373\00\Drawing\21-14-373-00 SEV SKETCH.dgn

REGISTERED

PLAN

131

THIS SKETCH WAS PREPARED FOR ALEX DROLIC AND THE UNDERSIGNED ACCEPTS NO RESPONSIBILITY FOR USE BY OTHER PARTIES.

Kerry F. Hillis
 KERRY F. HILLIS
 ONTARIO LAND SURVEYOR

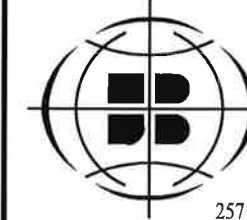

BSR&D ONTARIO LAND SURVEYORS SURVEYING
 URBAN & RURAL PLANNERS MAPPING
 A wholly owned subsidiary of J.D. Barnes Ltd. GIS

257 WOODLAWN ROAD WEST, UNIT 101, GUELPH, ON N1H 8J1
 T: (519) 822-4031 F: (519) 822-1220 www.jdbarnes.com

DRAWN BY: DM	CHECKED BY:	REFERENCE NO.: 21-14-373-00
PLOTTED: 3/17/2021	DATED: MARCH 17, 2021	