

O.P. LOW DENSITY RESIDENTIAL

R.IB-10 ZONE

ALICE 20.12 WIDE STREET

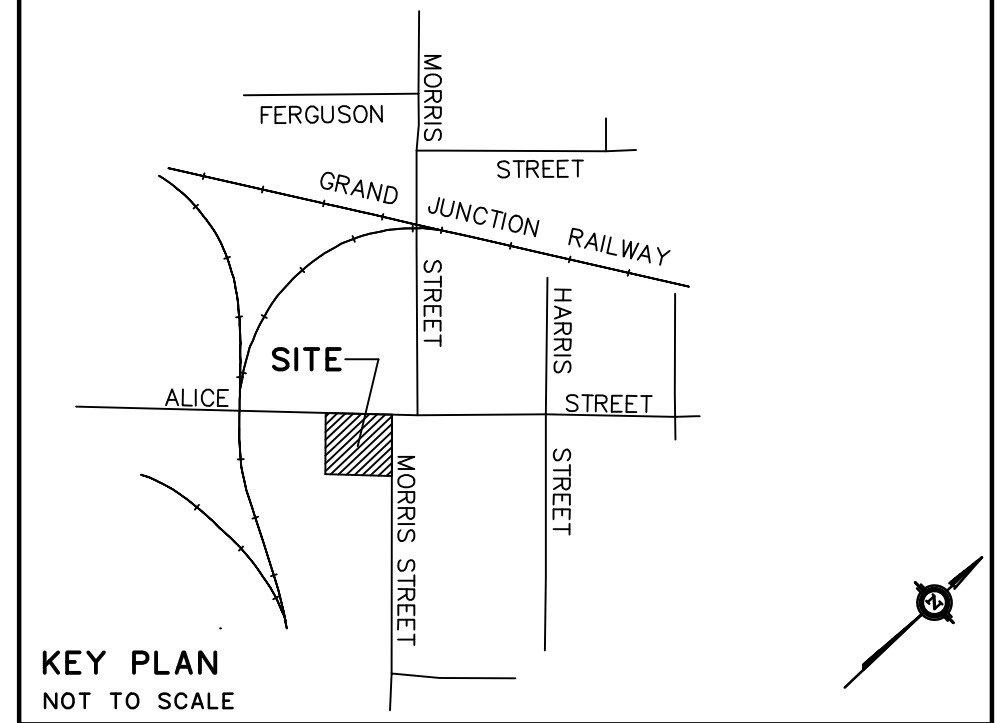
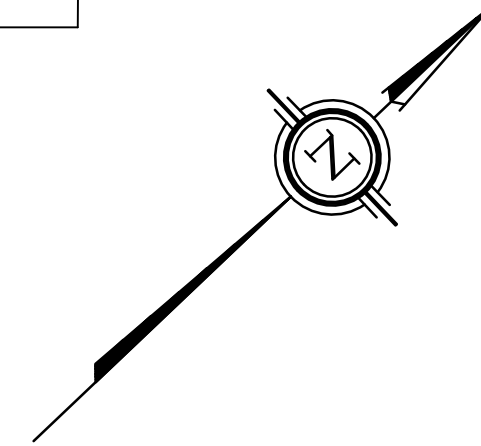

## PLAN

PREPARED FOR CONSENT APPLICATION  
CITY OF GUELPH  
COUNTY OF WELLINGTON

SCALE 1 : 200



**METRIC:** DISTANCES SHOWN ON THIS PLAN ARE IN METRES AND CAN BE CONVERTED TO FEET BY DIVIDING BY 0.3048

**CAUTION:** THIS IS NOT A PLAN OF SURVEY AND SHALL NOT BE USED EXCEPT FOR THE PURPOSE INDICATED IN THE TITLE BLOCK.

### NOTES:

- BOUNDARY INFORMATION AND AREAS SHOWN ON THIS PLAN HAVE BEEN COMPILED FROM A COMBINATION OF REGISTRY OFFICE RECORDS AND OLD SURVEYS AND IS SUBJECT TO VERIFICATION BY A COMPLETE UP-TO-DATE FIELD SURVEY.

### CITY OFFICIAL PLAN DESIGNATION:

RETAINED PARCEL: MIXED OFFICE / COMMERCIAL  
SEVERED PARCELS: MIXED OFFICE / COMMERCIAL

### CITY ZONING DESIGNATION:

RETAINED PARCEL: R.ID (H) ZONE  
SEVERED PARCELS: R.ID (H) ZONE

R.IB-10 ZONE

O.P. LOW DENSITY RESIDENTIAL

MORRIS 20.12 WIDE STREET

LANDSCAPE COMPANY  
with OUTDOOR STORAGE

LOT 2, RANGE 2, DIVISION 'F'

B.4-1

ZONE

REG'D

LOT

VACANT LAND

B.4-1 ZONE

File B-23/21  
PROPOSED PART 1  
(LANDS TO BE SEVERED)  
AREA = 336 sq.m.

File B-24/21  
PROPOSED PART 2  
(LANDS TO BE SEVERED)  
AREA = 275 sq.m.

167 Alice Street  
1 Storey Brick Building

156

PROPOSED PART 3  
(LANDS TO BE RETAINED)  
AREA = 641 sq.m.

293

157

SHED