

**EXISTING SITE PLAN** (NO CHANGES TO SITE AS PART OF NEW BASEMENT UNIT)  
 SCALE: 1/8" = 1'-0"  
**SITE PLAN NOTES**  
 ▽ MAIN FLOOR UNIT ENTRY  
 ▲ BASEMENT UNIT ENTRY  
 ZONING R,1B  
 BASED ON CITY OF GUELPH GIS MAP

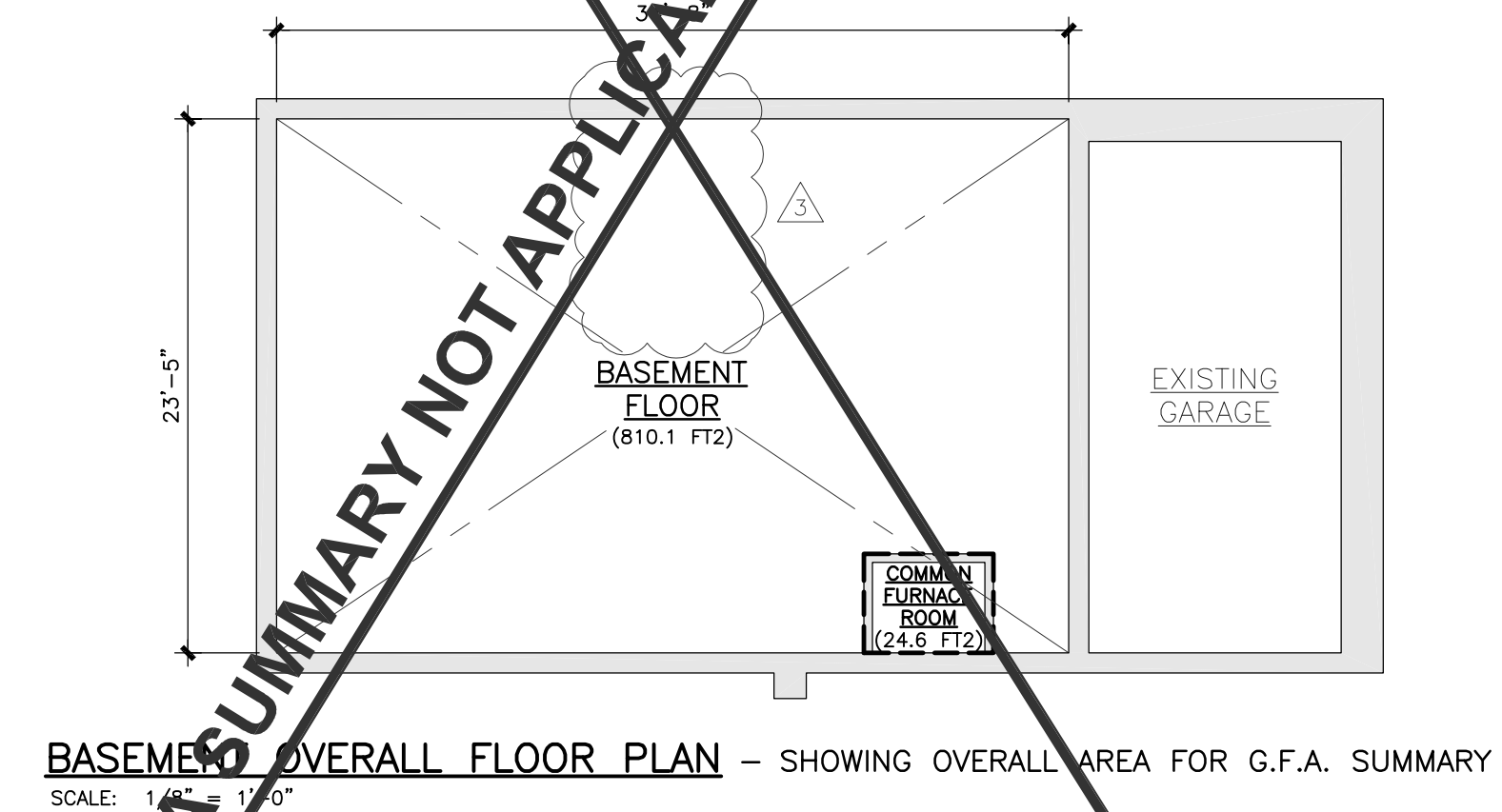
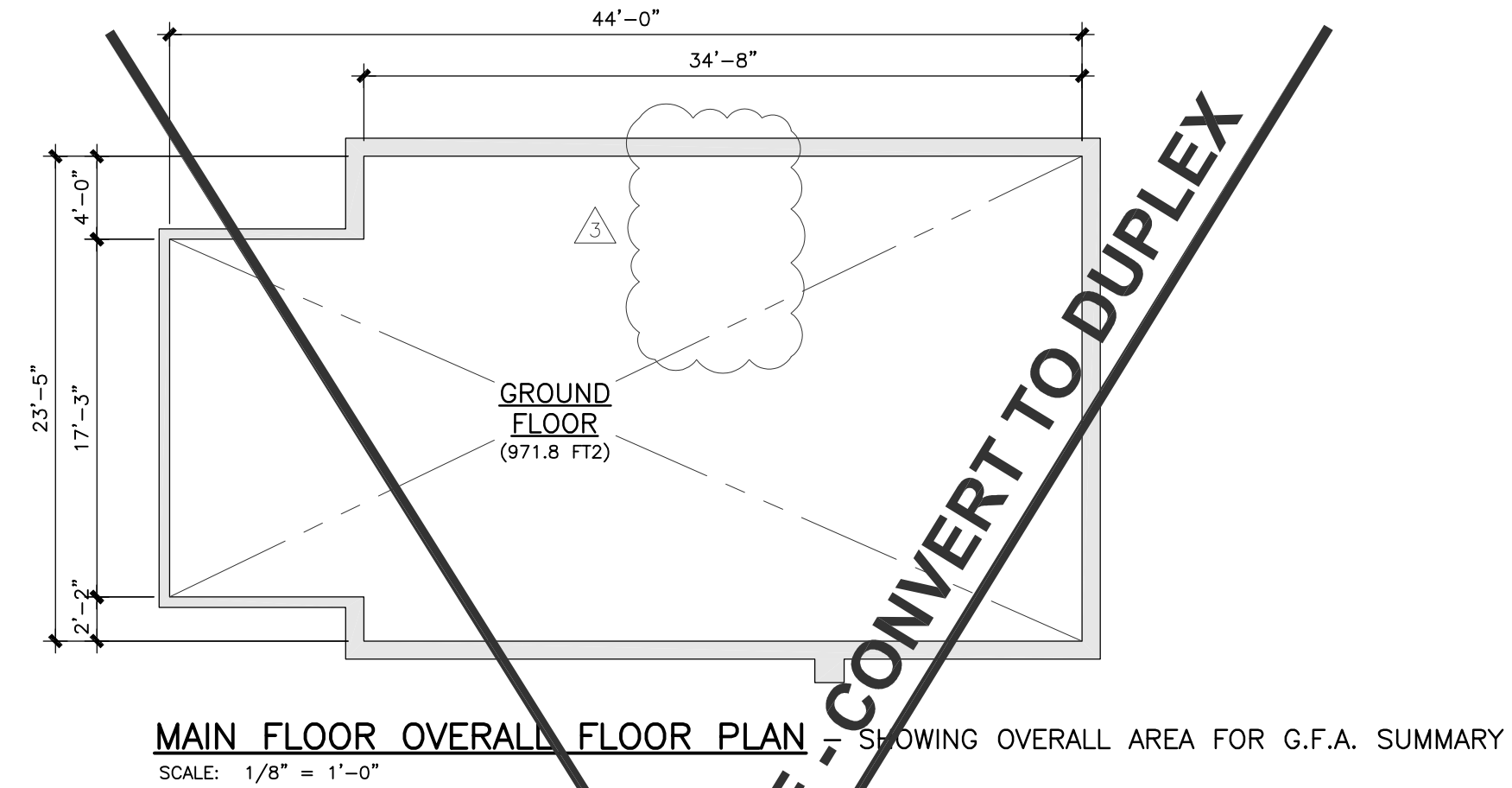

FLOOR AREA SUMMARY	
GROUND FLOOR AREA:	971.8 FT2
BASEMENT FLOOR AREA:	810.1 FT2
	1781.9 FT2 (GROSS FLOOR AREA)
COMMON ROOMS AREA:	24.6
BASEMENT UNIT FLOOR AREA:	810.1 - 24.6 = 785.5 FT2
BASEMENT UNIT PERCENTAGE OF G.F.A.:	785.5 / 1781.9 x 100% = 44% (LESS THAN 45%)

No.	Revision/Issue	Date
4	ENLARGED SITE PLAN AND ADDED INFO PER C of A	05 30 2023
3	CONVERT TO DUPLEX - DELETE INTERNAL STAIR	05 06 2023
2	ADDED EXISTING SITE PLAN	01 31 2023
1	BUILDING PERMIT	01 26 2023

OWNER:  
**SAMUAL ZAJDLIK**

Project:  
**NEW BASEMENT ACCESSORY UNIT**  
 83 BAGOT STREET  
 GUELPH, ON N1H 5T7

Drawing Title:  
**GFA SUMMARY PLANS AND EXISTING SITE PLAN**

Date: NOVEMBER 2022  
 Sheet: **2**  
 Scale: AS NOTED

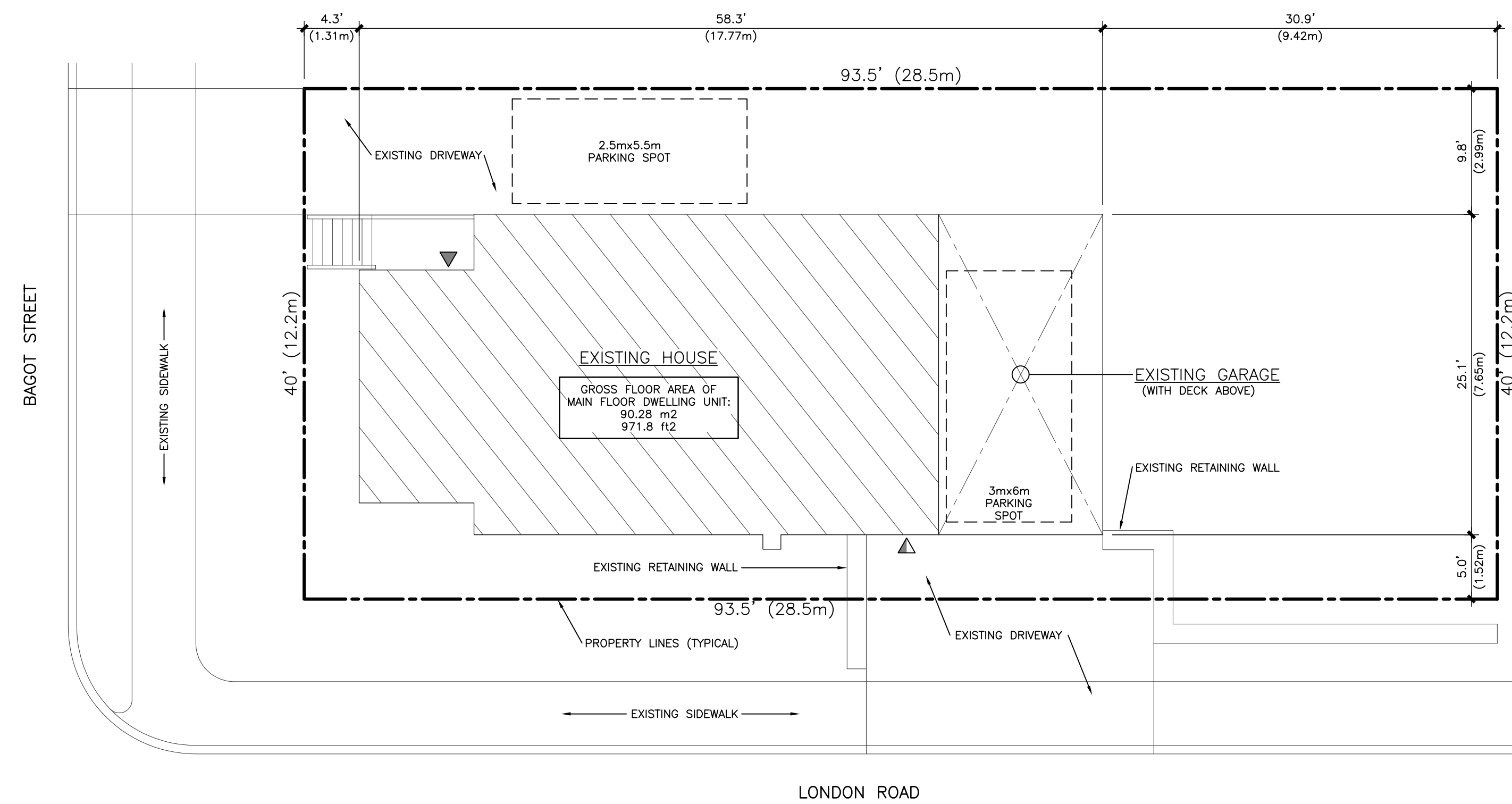
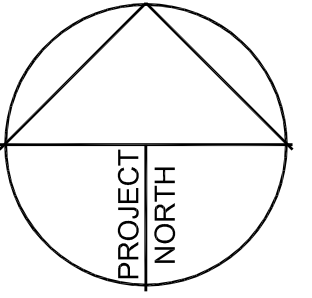

**EXISTING SITE PLAN** (NO CHANGES TO SITE AS PART OF NEW BASEMENT UNIT)  
 SCALE: 1/8" = 1'-0"  
**SITE PLAN NOTES**  
 ▽ MAIN FLOOR UNIT ENTRY  
 ▲ BASEMENT UNIT ENTRY  
 ZONING R.1B  
 BASED ON CITY OF GUELPH GIS MAP

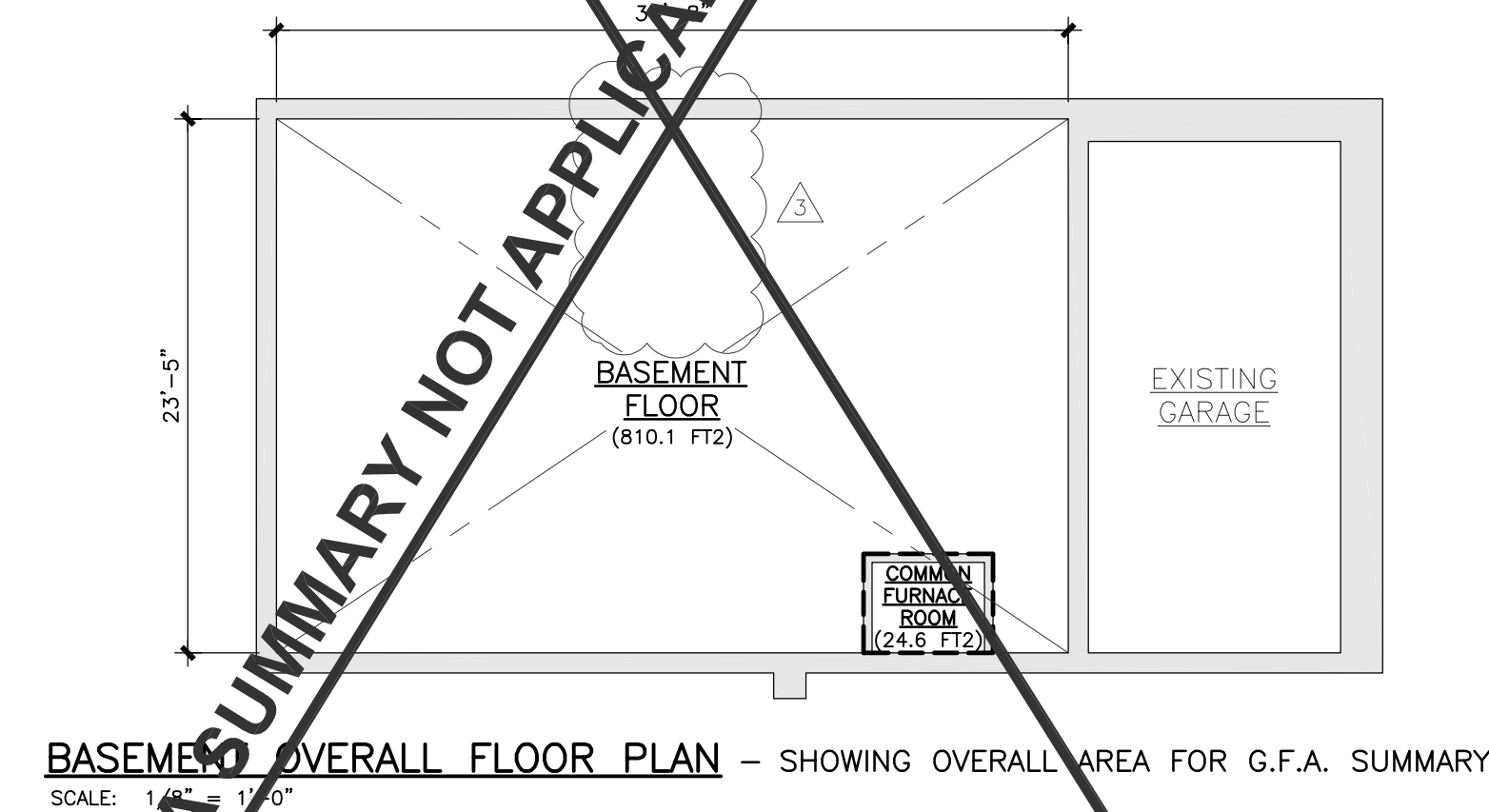
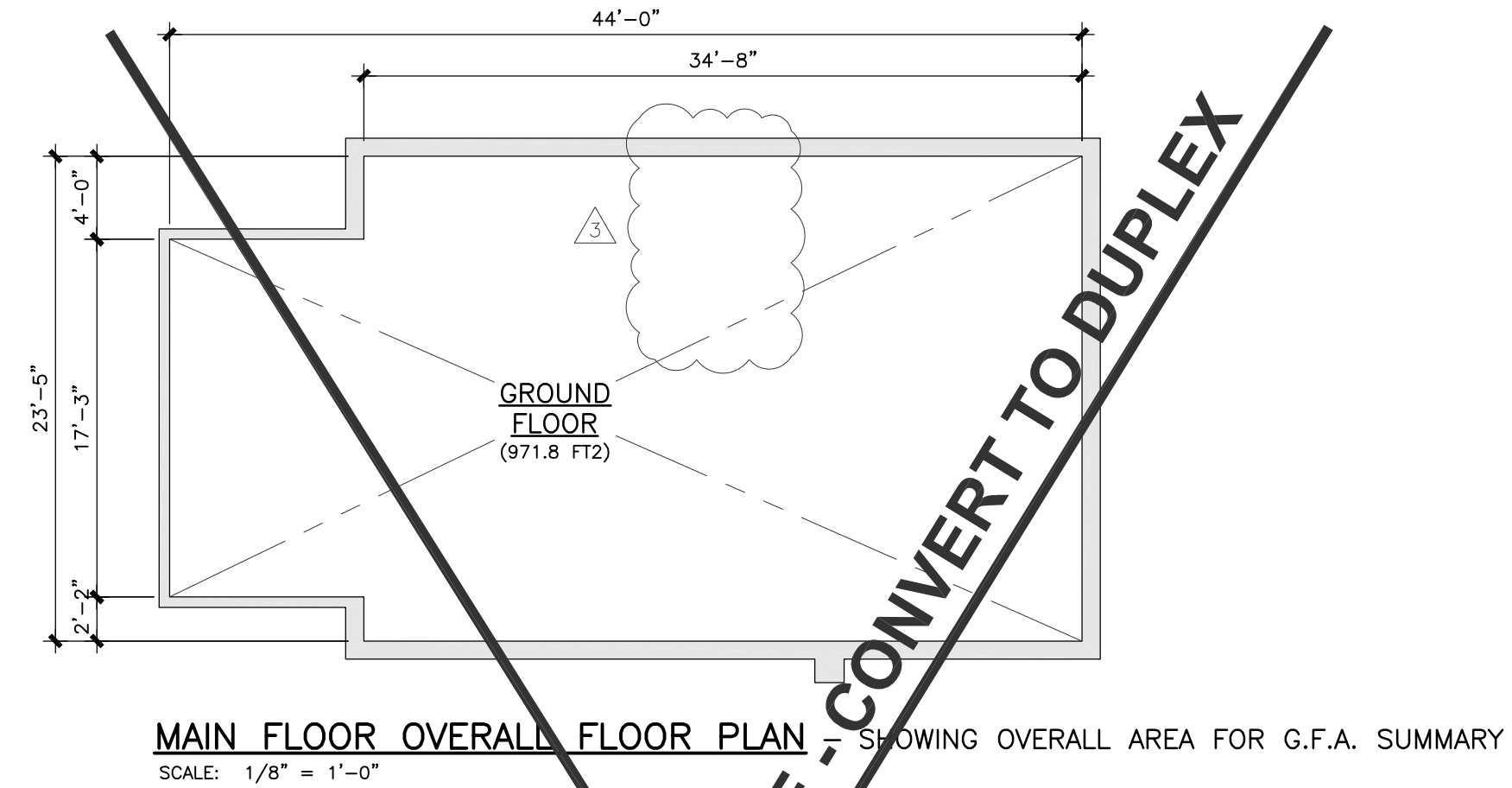

FLOOR AREA SUMMARY	
GROUND FLOOR AREA:	971.8 FT <sup>2</sup>
BASEMENT FLOOR AREA:	810.1 FT <sup>2</sup>
BASEMENT FLOOR AREA (GROSS FLOOR AREA)	
COMMON ROOMS AREA:	24.6
BASEMENT UNIT FLOOR AREA:	810.1 - 24.6 = 785.5 FT <sup>2</sup>
BASEMENT UNIT PERCENTAGE OF G.F.A.:	785.5 / 1781.9 x 100% = 44% (LESS THAN 45%)

No.	Revision/Issue	Date
4	ENLARGED SITE PLAN AND ADDED INFO PER C of A	05 30 2023
3	CONVERT TO DUPLEX - DELETE INTERNAL STAIR	05 06 2023
2	ADDED EXISTING SITE PLAN	01 31 2023
1	BUILDING PERMIT	01 26 2023

OWNER:  
 SAMUAL ZAJDLIK

Project:  
 NEW BASEMENT ACCESSORY UNIT  
 83 BAGOT STREET  
 GUELPH, ON N1H 5T7

Drawing Title:  
 GFA SUMMARY PLANS AND EXISTING SITE PLAN

Date: NOVEMBER 2022  
 Scale: AS NOTED  
 Sheet: 2