

Attachment-2: Historic Images and Documents

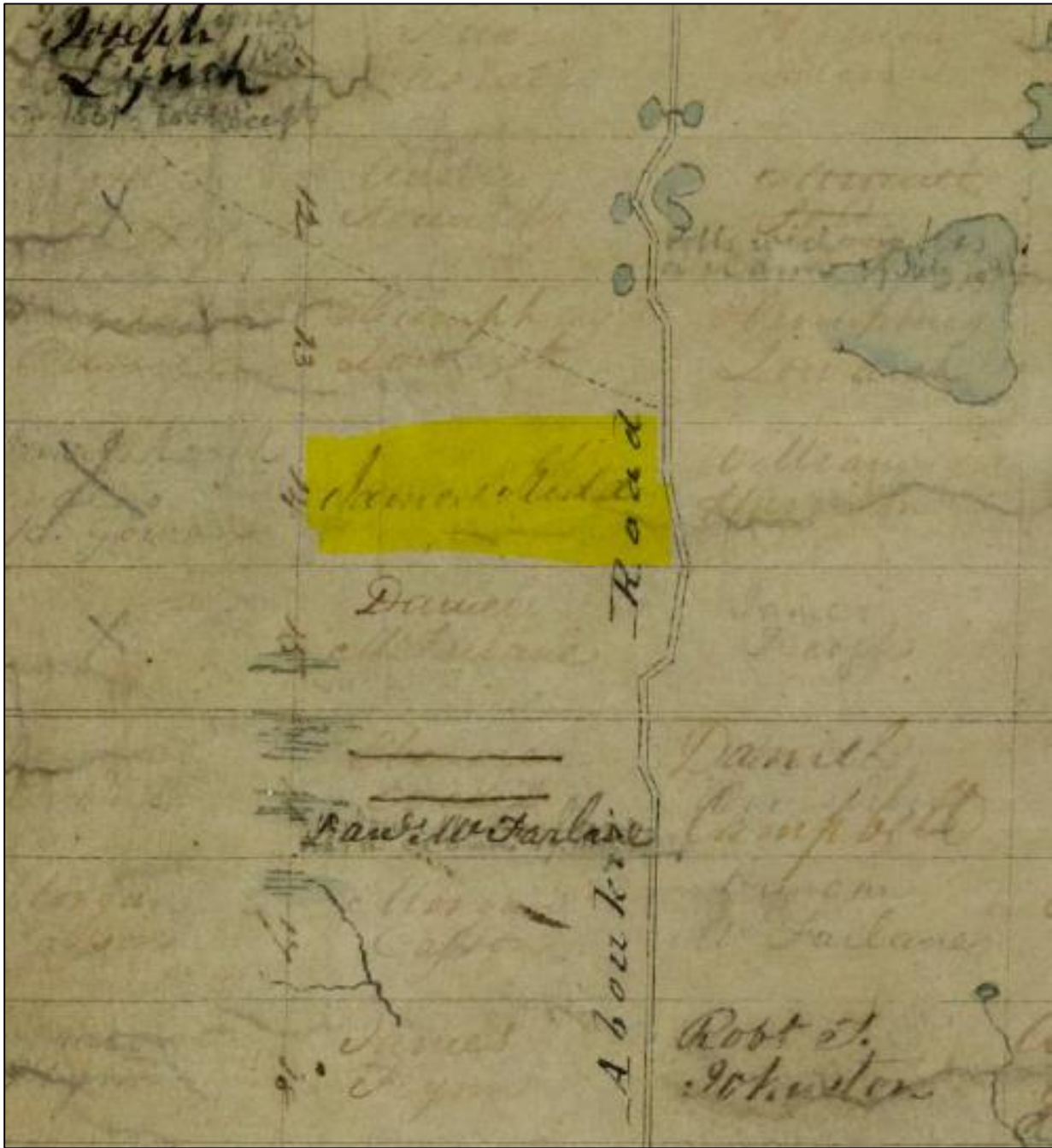

Figure 1: C. 1837 map of Puslinch featuring property of James Kidd

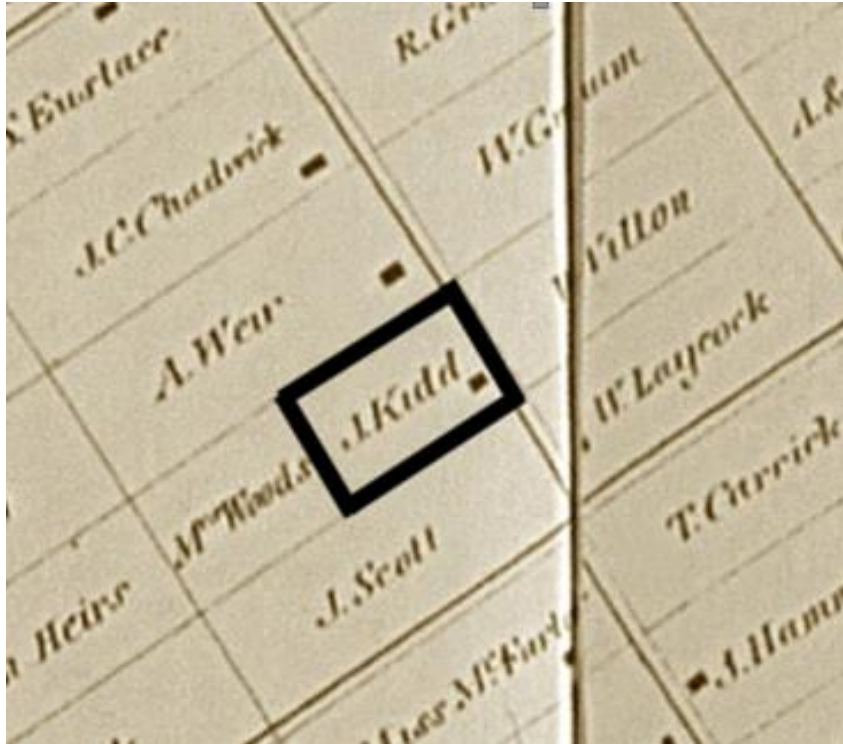

Figure 3: Close-up of Puslinch Township Historical Atlas of Waterloo & Wellington Counties, Ontario, Illustrated, 1877 Parsell, H & Co

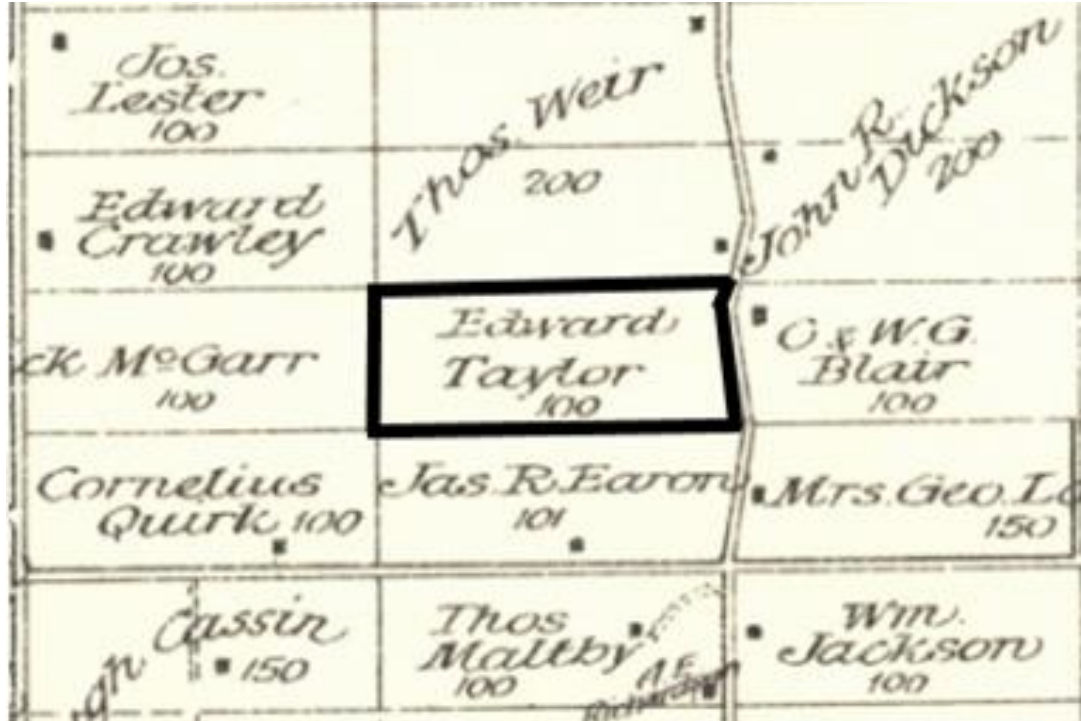

Figure 4: Wellington County 1906, Ontario published by Historical Atlas Publishing Co.

Selected entries from the land titles abstract. (OnLand: Land Registry
Access) Land Registry Records – Abstract Index

Instrument	Date Registered	Grantor (seller)	Grantee (buyer)	Quantity of Land	Amount of Mortgage	Remarks
Patent	23 Sept 1844	Crown	James Kidd	R Part 100		
Bargain & Sale 590	7 Mar 1846	James B Kidd and wife	Samuel Kidd	pt of Lot 14 48a. 35p		along? (illegible) of road
Bargain & Sale 3399	23 Jan 1852	Samuel Kidd	Joseph Kirby	pt of Lot 14 48a. 35p		
Mortgage 4081	23 Jan 1852	Joseph Kirby and wife	Samuel Kidd	pt of Lot 14 48a. 35p	£150	
Discharge of Mortgage 977	12 Jan 1860	Samuel Kidd	Joseph Kirby	pt of Lot 14 48a. 35p		mge 4081
Bargain & Sale 15929	1 Nov 1861	Joseph Kirby and wife	John Wood	pt of Lot 14 48a. 35p		with right of road
Mortgage 23087	3 Mar 1865	John Wood and wife	Hugh Cockburn Jr and Alexander Amos	pt of Lot 14 48a. 35p	\$350	with right of road
Discharge of Mortgage 92	12 Jan 1867	Hugh Cockburn Jr and Alexander Amos	Mary Wood	Part		Mtg 23087
Bargain & Sale 3976	28 Mar 1889	Louis L Vivian and John Vivian	Lydia Kidd	Rear Part 102 ac		Except 48a. 35p in (illegible) their undivided or interest

Bargain & Sale 4050	9 Nov 1889	William Wood and wife, Alexander Amos and David Wood heirs of John Wood deceased	Mary Wood	pt of Lot 14 48a. 35p		with right of road
Bargain & Sale 4061	3 Dec 1889	Lydia Kidd widow and exec. Of James B Kidd deceased	Mary Wood	Rear Part 102 ac		except part
Probate Will 7301	3 Apr 1905	Mary Wood widow deceased	her son Alexander	rear Part 100		
Bargain & Sale 7302	3 Apr 1905	Alexander Wood and wife	Edward Taylor	rear half 102 acres	\$2700.00	and right of road
Bargain & Sale 7499	24 Jun 1906	Edward Taylor and wife	William G Blair	rear half	\$2750.00	subject to mortgage
Bargain & Sale 7663	8 Oct 1907	William G Blair and wife	John Blair	rear half	\$1.00	subject to mortgage
Certificate 4138	24 Oct 1958	John N Blair deceased	Re: Estate of John Blair	rear half (as in 7663)		except parts
Grant 6702	1 Apr 1959	Ermine A Blair widow in her personal capacity and as executrix of John N Blair deceased	Catherine M Piotrowski	rear half	\$2.00	except parts

Lambell Esq. or
 the Agents for the Clergy
 Reserve Lands

James B. Kidd of
 Puslinch has paid the agents for the
 Clergy Reserve Land at Ammittown
 the whole of the money for Lot 14 in
 the 7th Concession in the
 Township of Puslinch. May I request
 you to inform me when the deed
 will be furnished to James B. Kidd.
 The reason I trouble you is this
 the said J. B. Kidd sold half his
 lot to a truly worthy man, and he gave
 this man a bond for to give him
 a deed when he the said J. B. Kidd
 received his deed. An answer in
 writing to me will give great

satisfaction. I wish to ask
 you, if in case a person can
 make a bargain with a squatter
 for the improvements he the squatter
 has made, can the Person who
 buys the squatters right or improvements
 would the purchaser be allowed
 to have it the land at the upset
 price, or according to your re-
 gulations. The lot is situated
 in Lot No 13 a 1/2 in the 7th
 Concession of Puslinch. —
 This said squatter has been upon
 the land about three years and
 has cleared from ten to twelve
 acres and the shell of a log house
 upon it.

If I am not troubling you
 too much may I request of you
 you an answer
 I am Sir
 Respectfully Yours
 James B. Kidd

N.B. There is a good lot of about
 twenty five acres in the 11th Concession
 and a road cuts it off from the
 lot. Would the Person purchase this
 you, also and what would the
 price be? What lot?

Figure 5: Inquiry on behalf of James Kidd for deed in order to sever lot 14 Concession 7 – Ontario Archives Courtesy Puslinch Historical Society

PUBLIC ARCHIVES OF CANADA MICROFILMED 1955

Township of *Windsor* County of *Windsor* 1861 109

AGRICULTURAL CENSUS, Enumeration District No. 3

NAME OF OCCUPIER	No. of Lots	NUMBER OF ACRES OF LAND				Total Value of Farm	Value of Buildings	Value of Stock	Value of Implements	Value of Horses	Value of Cattle	Value of Sheep	Value of Swine	Value of Poultry	Value of Other	Total Value	No. of Acres of Land	No. of Acres of Cultivated Land	No. of Acres of Pasture	No. of Acres of Wood	No. of Acres of Water	No. of Acres of Other	
		Concession or Range	Lot or part of Lot	No. of Acres of Land	Cash value of Farm, Dollars.																		
<i>Patrick Hughes</i>	1	72	57	38	20	1	48	2350	100	20	80	4	100	4	100	2	300	6	300	10			
<i>James Kidd</i>	1	62	40	30	9	1	22	2200	100	9	200	5	90	3	150	2	100	1	200	10			
<i>Conrad Schlegel</i>	1	151	60	30	30	1	21	3000	110	16	250	5	100	10	300	0	200	2	300	6			
<i>Robert Foster</i>	1	50	40	15	25	1	10	1200	30	5	30	2	50	2	80	1	100	2	200	3			
<i>Henry Foster</i>	1	50	40	16	24	1	10	1400	30	1	40	2	50	2	80	1	100	2	200	3			
<i>Conrad Miller</i>	1	102	80	30	8	2	20	3000	100	11	300	5	100	5	200	1	100	4	300	12			
<i>John Blackwell</i>	1	100	64	23	23	1	30	3000	100	10	250	5	100	5	100	1	100	1	200	12			
<i>James Stewart</i>	1	100	100	53	48	1	70	4000	100	10	200	5	250	5	200	1	100	4	300	12			
<i>John Thomson</i>	1	130	90	50	37	3	430	5000	400	15	400	8	100	16	300	1	200	3	300	15			
<i>Richard Hart</i>	1	100	80	60	18	2	20	3000	100	10	150	5	100	6	200	1	100	2	200	10			
<i>George Walter</i>	1	103	75	60	12	5	28	3000	100	6	150	5	100	10	200	1	100	2	200	10			
<i>John Kelly</i>	1	66	48	30	5	2	21	3000	100	10	100	5	100	10	200	10	200	10	200	8			
<i>Robert A. Lindsay</i>	1	30	20	10	10	1	10	1000	30	15	200	5	100	15	200	3	100	1	100	3			
<i>Henry W. Smith</i>	1	3	3	3	3	1	3	300	10	3	30	1	30	3	30	1	30	1	30	3			
<i>John Carter</i>	1	185	100	50	50	1	15	5000	300	10	200	5	200	5	200	1	100	3	300	15			
<i>John G. Brown</i>	1	50	40	28	22	1	14	1400	200	5	100	4	100	4	100	1	100	1	100	15			
<i>William Land</i>	1	100	50	30	10	1	50	1000	100	10	200	2	100	4	100	1	100	1	100	6			
<i>William Kennedy</i>	1	96	60	44	15	1	136	3000	200	15	200	5	200	5	200	1	100	4	300	3			
<i>James Land</i>	1	100	80	60	18	2	20	3000	100	15	200	5	200	7	200	10	200	5	300	10			
<i>John Cook</i>	1	50	40	30	10	1	10	2000	200	10	200	2	50	3	200	2	200	2	200	2			
<i>John West</i>	1	100	65	40	20	1	35	4000	100	12	200	5	100	4	200	10	200	3	300	12			
<i>James Kidd</i>	1	52	30	25	14	1	12	2000	200	6	100	4	100	1	100	1	100	1	100	1			
<i>John Stewart</i>	1	100	80	60	17	3	20	3000	100	10	200	5	100	4	100	10	200	3	300	10			
<i>James W. Brown</i>	1	100	60	50	18	2	40	4000	100	10	200	5	100	4	100	10	200	3	300	20			
<i>William Easton</i>	1	150	120	70	48	2	30	5000	400	20	300	5	100	10	200	20	300	4	400	10			
<i>James W. Kelly</i>	1	100	60	30	30	1	30	3000	200	10	200	4	100	2	100	1	100	3	300	3			
<i>William West</i>	1	100	60	40	20	1	40	4000	300	15	300	5	100	6	100	3	300	3	300	4			
<i>John West</i>	1	100	60	35	25	1	10	2000	30	15	100	1	25	2	100	2	100	2	100	3			
<i>James Brown</i>	1	100	80	50	28	2	20	3000	200	10	200	5	100	4	100	10	200	2	200	10			
<i>John Brown</i>	1	100	80	50	28	2	20	3000	200	10	200	5	100	4	100	10	200	2	200	10			
<i>John Brown</i>	1	100	80	50	28	2	20	3000	200	10	200	5	100	4	100	10	200	2	200	10			
<i>John Brown</i>	1	100	80	50	28	2	20	3000	200	10	200	5	100	4	100	10	200	2	200	10			
<i>John Brown</i>	1	100	80	50	28	2	20	3000	200	10	200	5	100	4	100	10	200	2	200	10			
<i>John Brown</i>	1	100	80	50	28	2	20	3000	200	10	200	5	100	4	100	10	200	2	200	10			
<i>John Brown</i>	1	100	80	50	28	2	20	3000	200	10	200	5	100	4	100	10	200	2	200	10			
<i>John Brown</i>	1	100	80	50	28	2	20	3000	200	10	200	5	100	4	100	10	200	2	200	10			
<i>John Brown</i>	1	100	80	50	28	2	20	3000	200	10	200	5	100	4	100	10	200	2	200	10			
<i>John Brown</i>	1	100	80	50	28	2	20	3000	200	10	200	5	100	4	100	10	200	2	200	10			
<i>John Brown</i>	1	100	80	50	28	2	20	3000	200	10	200	5	100	4	100	10	200	2	200	10			
<i>John Brown</i>	1	100	80	50	28	2	20	3000	200	10	200	5	100	4	100	10	200	2	200	10			
<i>John Brown</i>	1	100	80	50	28	2	20	3000	200	10	200	5	100	4	100	10	200	2	200	10			
<i>John Brown</i>	1	100	80	50	28	2	20	3000	200	10	200	5	100	4	100	10	200	2	200	10			
<i>John Brown</i>	1	100	80	50	28	2	20	3000	200	10	200	5	100	4	100	10	200	2	200	10			
<i>John Brown</i>	1	100	80	50	28	2	20	3000	200	10	200	5	100	4	100	10	200	2	200	10			
<i>John Brown</i>	1	100	80	50	28	2	20	3000	200	10	200	5	100	4	100	10	200	2	200	10			
<i>John Brown</i>	1	100	80	50	28	2	20	3000	200	10	200	5	100	4	100	10	200	2	200	10			
<i>John Brown</i>	1	100	80	50	28	2	20	3000	200	10	200	5	100	4	100	10	200	2	200	10			
<i>John Brown</i>	1	100	80	50	28	2	20	3000	200	10	200	5	100	4	100	10	200	2	200	10			
<i>John Brown</i>	1	100	80	50	28	2	20	3000	200	10	200	5	100	4	100	10	200	2	200	10			
<i>John Brown</i>	1	100	80	50	28	2	20	3000	200	10	200	5	100	4	100	10	200	2	200	10			
<i>John Brown</i>	1	100	80	50	28	2	20	3000	200	10	200	5	100	4	100	10	200	2	200	10			
<i>John Brown</i>	1	100	80	50	28	2	20	3000	200	10	200	5	100	4	100	10	200	2	200	10			
<i>John Brown</i>	1	100	80	50	28	2	20	3000	200	10	200	5	100	4	100	10	200	2	200	10			
<i>John Brown</i>	1	100	80	50	28	2	20	3000	200	10	200	5	100	4	100	10	200	2	200	10			
<i>John Brown</i>	1	100	80	50	28	2	20	3000	200	10	200	5	100	4	100	10	200	2	200	10			
<i>John Brown</i>	1	100	80	50	28	2	20	3000	200	10	200	5	100	4	100	10	200	2	200	10			
<i>John Brown</i>	1	100	80	50	28	2	20	3000	200	10	200	5	100	4	100	10	200	2	200	10			
<i>John Brown</i>	1	100	80	50	28	2	20	3000	200	10	200	5	100	4	100	10	200	2	200	10			
<i>John Brown</i>	1	100	80	50	28	2	20	3000	200	10	200	5	100	4	100	10	200	2	200	10			
<i>John Brown</i>	1	100	80	50	28	2	20	3000	200	10	200	5	100	4	100	10	200	2	200	10			
<i>John Brown</i>	1	100	80	50	28	2</																	

ASSESSMENT ROLL FOR THE Township of Puslinch 1874									
NAME OF TAXABLE PARTIES					CLASSIFICATION OF				
Number on Roll	NAME OF TAXABLE PARTY	OCCUPATION	Householder or Tenant	Age	No. of Concessions	No. of Lots	No. of Acres	Value of Real Property	Value of Personal Property
173	Angam Thomas	Farmer	F	66	4	R7	18	100 70	1200
174	Jacob Benjamin	Farmer	F	27	1	R7	50	100 60	1500
175	Jacobson William			30					
176	Jacobson Samuel			10	3	R4	18	100 70	1400
177	Jacobson William	Teacher	F	33	4	R7	19	4 houses	75 75 75
178	Kristina M. Jacob	Widow	F	60	2	R1	26	75 30	500
179	Kristina James	Farmer	F	77	12	R7	14	52 40	500
180	Kennedy Harold		F	56	2	R7	10	50 40	900
181	Stewart William		F	37	7	R1	11	100 60	1300
182	Stewart Lewis			0					
183	Stratton J.		F	27	11	R2	8	100 70	1600
184	Stewart Frank	Carpenter	F	31	8	R2	37.32	75 30	500
185	Stramp Friedrich	Farmer	F	26	5	R3	11	50 60	700
								652.25	11150
								1376	12526
								7	72
								47	1022

Figure 8: 1874 Township of Puslinch Tax Assessment; Line 179 denotes James Kidd's information.

Name	Occupation	Householder, Freeholder or Tenant.	Age	No. of Concessions	No. of Lots	No. of Acres	Value of Real and Personal Property	Date of delivery of Notice
Kidd James	Farmer	F	77	R7	14	52	950	8 March

Figure 9: Transcribed relevant information from 1874 Tax Assessment

158

SCHEDULE C.—DEATHS.

Registration District of *Wellington* Division of *Puslinch*

No. 7	No. 8	No. 9
<p>Name and Surname of Deceased. <i>Joseph Kirby</i></p> <p>When died. <i>Feb. 10th 1878</i></p> <p>Sex—Male or Female. <i>Male</i></p> <p>Age. <i>5 1/2 Years</i></p> <p>Rank or Profession. <i>Labourer</i></p> <p>Where Born. <i>North Shire, England</i></p> <p>Certified cause of Death, and duration of Illness. <i>Apoplexy of Brain</i></p> <p>Name of Physician, if any. <i>Dr. Keating, Guelph</i></p> <p>Signature, description and residence of informant. <i>Thomas A. Keating M.D. Guelph</i></p> <p>When Registered. <i>February 13th 1878</i></p> <p>Religious Denomination of Deceased. <i>Episcopalian</i></p> <p>Signature of Registrar. <i>Samuel W. Shaw</i></p> <p>REMARKS. <i>015509</i></p>	<p>Name and Surname of Deceased. <i>Sarah Jane Gage</i></p> <p>When died. <i>Feb. 25th 1878</i></p> <p>Sex—Male or Female. <i>Female</i></p> <p>Age. <i>2 1/2 Years</i></p> <p>Rank or Profession. <i>Nurse</i></p> <p>Where Born. <i>Puslinch, Ont.</i></p> <p>Certified cause of Death, and duration of Illness. <i>Scm aft. Chisabitts</i></p> <p>Name of Physician, if any. <i>Dr. Brown Galt</i></p> <p>Signature, description and residence of informant. <i>Leus Ferguson Killeam</i></p> <p>When Registered. <i>March 4th 1878</i></p> <p>Religious Denomination of Deceased. <i>Presbyterian</i></p> <p>Signature of Registrar. <i>Samuel W. Shaw</i></p> <p>REMARKS. <i>015530</i></p>	<p>Name and Surname of Deceased. <i>Robert Clark</i></p> <p>When died. <i>Feb. 24th 1878</i></p> <p>Sex—Male or Female. <i>Male</i></p> <p>Age. <i>6 1/2 Years</i></p> <p>Rank or Profession. <i>Yeoman</i></p> <p>Where Born. <i>Scotland</i></p> <p>Certified cause of Death, and duration of Illness. <i>Ulceration of Right Lung</i></p> <p>Name of Physician, if any. <i>6 Months</i></p> <p>Signature, description and residence of informant. <i>Richard Ortow M.D. Morriston</i></p> <p>When Registered. <i>March 4th 1878</i></p> <p>Religious Denomination of Deceased. <i>Presbyterian</i></p> <p>Signature of Registrar. <i>Samuel W. Shaw</i></p> <p>REMARKS. <i>015501</i></p>
<p>Name and Surname of Deceased. <i>William Stewart</i></p> <p>When died. <i>February 28th 1878</i></p> <p>Sex—Male or Female. <i>Male</i></p> <p>Age. <i>77 Years</i></p> <p>Rank or Profession. <i>Yeoman</i></p> <p>Where Born. <i>Scotland</i></p> <p>Certified cause of Death, and duration of Illness. <i>Paralysis of Liver</i></p> <p>Name of Physician, if any. <i>Richd Ortow M.D. Morriston</i></p> <p>Signature, description and residence of informant. <i>Dr. Ortow Morriston</i></p> <p>When Registered. <i>March 7th 1878</i></p> <p>Religious Denomination of Deceased. <i>Presbyterian</i></p> <p>Signature of Registrar. <i>Samuel W. Shaw</i></p> <p>REMARKS. <i>015502</i></p>	<p>Name and Surname of Deceased. <i>Mrs John McQueen</i></p> <p>When died. <i>March 14th 1878</i></p> <p>Sex—Male or Female. <i>Female</i></p> <p>Age. <i>23 Years</i></p> <p>Rank or Profession. <i>Nurse</i></p> <p>Where Born. <i>Puslinch</i></p> <p>Certified cause of Death, and duration of Illness. <i>Suppuration of Uterus 9 days</i></p> <p>Name of Physician, if any. <i>Dr. Brown Galt</i></p> <p>Signature, description and residence of informant. <i>Dr. Brown Galt</i></p> <p>When Registered. <i>March 18th 1878</i></p> <p>Religious Denomination of Deceased. <i>Presbyterian</i></p> <p>Signature of Registrar. <i>Samuel W. Shaw</i></p> <p>REMARKS. <i>015503</i></p>	<p>Name and Surname of Deceased. <i>James Beresford Kidd</i></p> <p>When died. <i>March 18th 1878</i></p> <p>Sex—Male or Female. <i>Male</i></p> <p>Age. <i>78 Years</i></p> <p>Rank or Profession. <i>Yeoman</i></p> <p>Where Born. <i>England</i></p> <p>Certified cause of Death, and duration of Illness. <i>Opisthema with uraemic poisoning of the blood. smokes etc</i></p> <p>Name of Physician, if any. <i>Richard Ortow M.D.</i></p> <p>Signature, description and residence of informant. <i>Dr. Ortow Morriston</i></p> <p>When Registered. <i>March 18th 1878</i></p> <p>Religious Denomination of Deceased. <i>Episcopalian</i></p> <p>Signature of Registrar. <i>Samuel W. Shaw</i></p> <p>REMARKS. <i>015504</i></p>

I hereby certify the foregoing to be the true and correct entries of all Deaths returned to me for the year ending 31st December, 1878.

Edw. H. B. Registrar

Figure 10: 1878 Death Register; James Kidd's information is located in the bottom right segment.

Name and Surname of Deceased	When died	Sex- Male or Female	Age	Rank or Profession	Where Born
James Beresford Kidd	March 18 th 1878	Male	78 years	Yeoman	England

Cont'd

Name of Physician	When registered	Religious denomination of deceased
Richard Ortow M.D.	March 18 th 1878	Episcopalian

Figure 11: Transcription of relevant information from the 1878 Puslinch death records.

ASSESSMENT ROLL FOR THE MUNICIPALITY OF *Puslinch for the Year* 1880. 14

No.	NAME OF TAXABLE PARTIES				AGE AND RESIDENCE OF				REAL PROPERTY		PERSONAL PROPERTY		MONEY LOANS		DEBITORS		Total Value of Real and Personal Property and Taxable Income	
	NAME OF TAXABLE PARTY	OCCUPATION	Householder, Freeholder, or Tenant	Age	No. of Acres	Value of Real Property	Value of Personal Property	Value of Money Loans	Value of Debtors	Value of Real Property	Value of Personal Property	Value of Money Loans	Value of Debtors	Value of Real Property	Value of Personal Property	Value of Money Loans		Value of Debtors
360	Jacob Benjamin	farmer	H	48	Acres 7	200 50			1500	200			1300	6	1	6	1000	20
361	Johnson William	farmer	H	48	front 19	100 50			1500	300			2100	4	1	3	1000	10
362	Johnson Philip P	farmer	H	48	12 front	4	50 50		200				200	2	1	3	100	5
363	Jackson Robert	blacksmith	H	48	Acres 9	4	50 50		150				150	2	1	6	100	5
364	Jackson John	farmer	H	48	front 9	3	60 60		150				150	2			100	5
365	Jackson William	farmer	H	48	Acres 18	2	100 50		1500	200			1700	6	1	5	1000	20
366	King David	farmer	H	48	front 15	6	100 50		2000	300			2300	7	1	5	1000	20
367	Kennedy Margaret	farmer	H	48	Acres 11	8	100 50		1500	150			1650	5	1	5	1000	20
368	Kennedy William	farmer	H	48	Acres 23	2	100 50		1500	150			1650	5	1	5	1000	20
369	Kennedy John	farmer	H	48	Acres 23	2	100 50		1500	150			1650	5	1	5	1000	20
370	Kennedy John	farmer	H	48	Acres 23	2	100 50		1500	150			1650	5	1	5	1000	20
371	Kennedy James	farmer	H	48	Acres 23	2	100 50		1500	150			1650	5	1	5	1000	20
372	Kidd Mrs James	Window	H	48	Rear 7	14	1025		1025	125			1150	5	1	4	1025	1025
373	Kennedy Robert	farmer	H	48	front 10	38-38	100 50		1500				1500	5	1	5	1000	20
374	Kidd Mrs James	Window	H	48	Rear 7	14	1025		1025	125			1150	5	1	4	1025	1025
375	Kerr William	farmer	H	48	front 10	21	100 50		1500	200			1700	6	1	5	1000	20
376	Kerrington Thomas	farmer	H	48	Acres 11	6	100 50		1500	200			1700	6	1	5	1000	20
377	Kerrington James	farmer	H	48	Acres 11	6	100 50		1500	200			1700	6	1	5	1000	20
378	Kirkland William	farmer	H	48	Acres 11	6	100 50		1500	200			1700	6	1	5	1000	20
379	Kidd Mrs James	Window	H	48	Rear 7	14	1025		1025	125			1150	5	1	4	1025	1025
380	Kerrington Thomas	farmer	H	48	Acres 11	6	100 50		1500	200			1700	6	1	5	1000	20
381	Kerrington James	farmer	H	48	Acres 11	6	100 50		1500	200			1700	6	1	5	1000	20
382	Kerrington Frank	farmer	H	48	Acres 11	6	100 50		1500	200			1700	6	1	5	1000	20
383	King David	farmer	H	48	Acres 11	6	100 50		1500	200			1700	6	1	5	1000	20
384	Kerrington Edward	farmer	H	48	Acres 11	6	100 50		1500	200			1700	6	1	5	1000	20
385	Kerrington William	farmer	H	48	Acres 11	6	100 50		1500	200			1700	6	1	5	1000	20

Figure 12: 1880 Township of Puslinch Tax Assessment. Line 372 denotes the information of Mrs. James Kidd.

Name of Taxable Party	Occupation	Householder, Freeholder, or Tenant	No. of Concession, Name of Street etc.	No. of Lot, House	Total value of Real and Personal Property and Taxable Income
Kidd Mrs. James	Window	H	Rear 7	14	1025

Figure 13: Table of transcribed relevant information from 1880 Township of Puslinch Tax Assessment.



Figure 14: James Kidd's Grave at Arkell Methodist Church Cemetery, 2015. No birth date available; possible June 19, 1801

Email correspondence from Marjorie Clark to Jesse Watson at City of Guelph contained the obits below for James and Lydia Kidd:

KIDD, JAMES B.

Another Gone

Early on Monday morning, March 18, 1878, aged 79 years, at his residence, lot 14, 7th concession, Puslinch. He settled in the township in the year 1829, on the same lot on which he died. He was among the earliest settlers and was one who carved his home out of the dreary wilderness. He was widely known and highly respected. One by one the old landmarks are thus disappearing, leaving behind them a good name and kindly remembered by all who knew them. Mr. Kidd was twice married and leaves a wife and large family.

--- Buried at Arkell United Church Cemetery.

KIDD, LYDIA "LIDDIE" (Nee Watling)

Mrs. James Kidd, at Guelph General Hospital, on Saturday, 12th January 1907, in her 75th year. She had been ailing since fall and her death was not unexpected. Born in England, she came to Canada when 4 years old with her parents and lived at Aberfoyle nearly all her life. Mr. Kidd predeceased her twenty-eight years ago. Three sons and four daughters survive: William of St. Louis; Isaac of Aberfoyle; Mrs. John Vivien of Coldwater, Simcoe County; Mrs. Louis Cannon of Flesherton; George of Coldwater; Sarah of Guelph; and Mrs. Hodgkin of Guelph. Mrs. Kidd was a Methodist and an active member of the church until a short time ago. She has been living with her daughter, Mrs. Hodgkin since the fall until two weeks ago, when she was removed to the hospital. The funeral took place from her daughter's residence, Mrs. F. W. Hodgkin of 29 Edwin St. in Guelph on Monday at 4 to Union Cemetery. Rev. L. F. Barber conducted the service.

--- Information from the death certificate: Cause of death was gangrene, from which she suffered for 1 month.