

**SITE STATISTICS**

595 ELMIRA ST N. MULTIBUILDING SELF STORAGE DEVELOPMENT			
ZONING BYLAW	1995 - 14864		
ZONING	SC (SC.2-2)		
	REQ/PERM	EXISTING	PROPOSED
SITE AREA		17,734.2 SM	
GROUND FLOOR AREA		6,089.1 SM	6,081.0 SM
BUILDING AREA		GFA	GFA
EXISTING		6,089.1 SM	
DEMOLISHED		1,410.1 SM	
NEW			5,668.0 SM
TOTAL			10,267.0 SM
PARKING: (1.0 SP/50 SM)			
2.75 X 5.5+2.6 X 6.5	12 SP	12 SP	50 SP
EXIST 6089.1 SM	84 SP		50 SP
ADDL 4,197.9 SM	96 SP		
TOTAL			
BF PARKING(INCL ABOVE)			
A=2.4 X 5.5	2 SP	0 SP	2 SP
B=3.4 X 5.5	2 SP	0 SP	2 SP
BICYCLE PARKING			
0.6M X 1.7M			
INSIDE (LONG TERM)	4	0	4
OUTSIDE (SHORT TERM)	2	0	5
LOADING: (4.5 X 9.0 M)		0	2
SETBACKS			
FRONT(WEST)	6.0 M	17.2 M	17.3 M
NORTH	3.0 M	4.7 M	4.7 M
SOUTH	3.0 M	3.0 M	3.0 M
REAR(EAST)	6.0 M	6.1 M	6.1 M
BUILDING HEIGHT	5 STY(APPROX 20M)	3.7 M	16.64 M(ELEV:356.60)
LANDSCAPING	10% = 1,774 SM	UNK	2,373.2 SM (13.4%)
	3.0M FRONT	UNK	3.0M FRONT

**Project Information**

595 ELMIRA RD. N.  
PART OF LOT 1, CON 6, DIVISION 'D'  
CITY OF GUELPH  
COUNTY OF WELLINGTON

SURVEY INFO FROM  
VAN HARTEN SURVEYING INC.  
REF. PROJ. NO. 30594-21  
JAN. 11, 2022

DRAWINGS INFORMATION FROM  
DRAWINGS BY  
RANKIN ARCHITECT INC.  
PROJECT 9921 DATED AUG. 1999

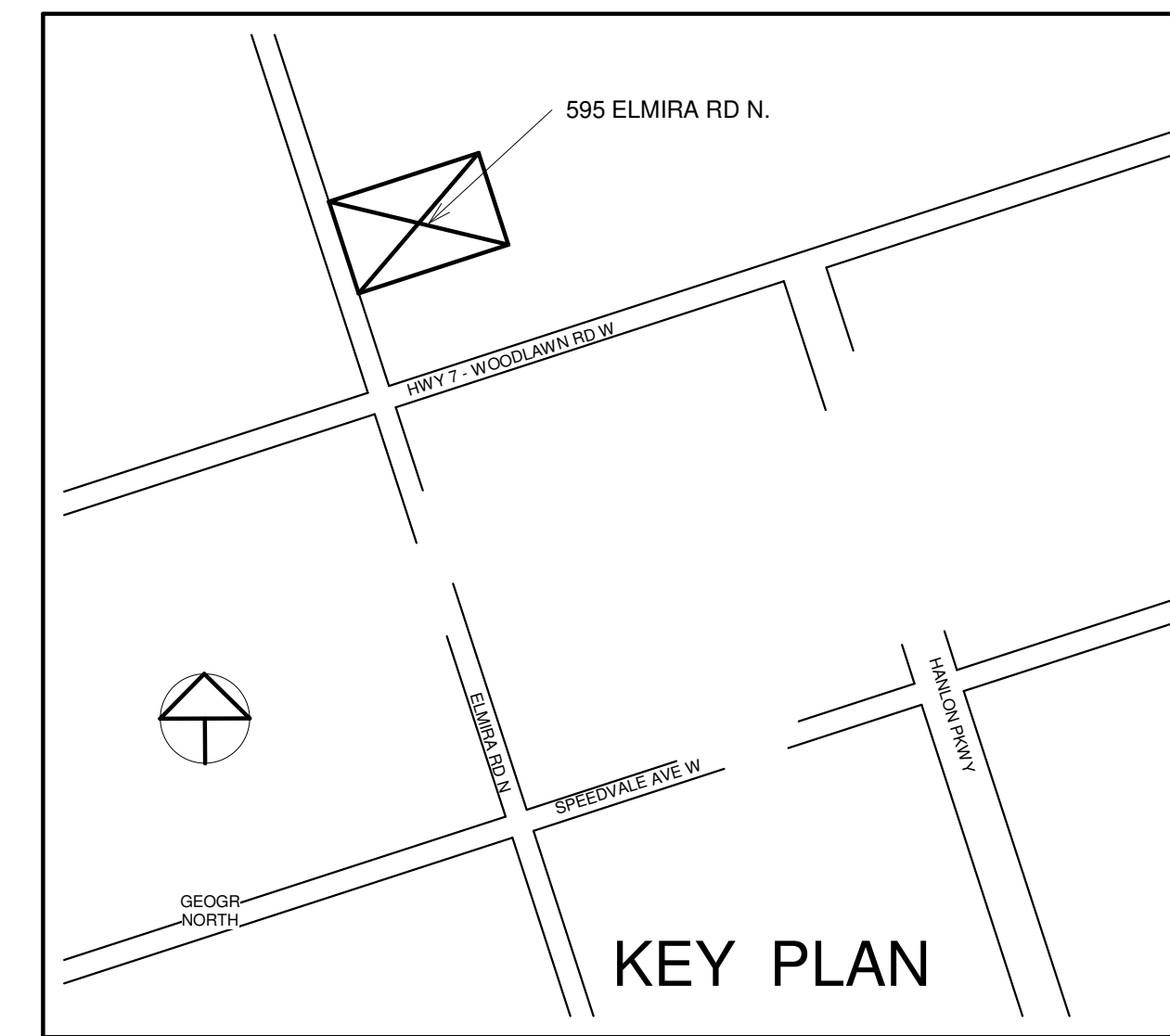
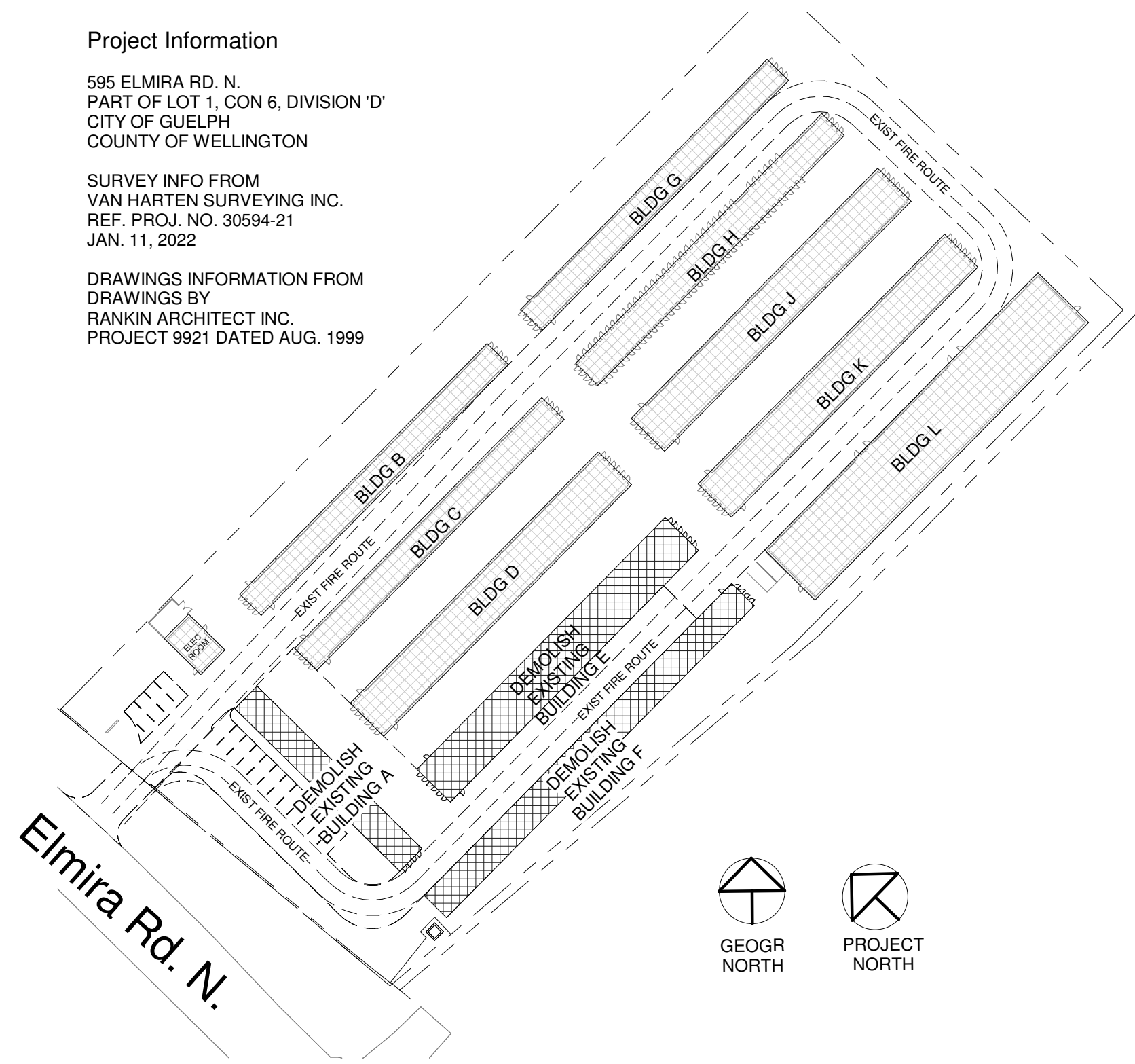

**LEGEND**

- 0000 DOOR NUMBER - SEE DOOR SCHEDULE
- 000 WINDOW TYPE - SEE WINDOW SCHEDULE
- 000 WALL TYPE - SEE WALL SCHEDULE
- RB93 ACCESSIBLE PARKING SIGN AS PER GUELPH 2015 FADM
- VAN TAB TAB ADDED TO RB93 SIGN FOR VANS AS PER GUELPH 2015 FADM
- TWSI TACTILE WARNING SAFETY INDICATOR AS PER GUELPH 2015 FADM

2 Site  
1 : 350

3 Site Demolition Plan  
1 : 1000

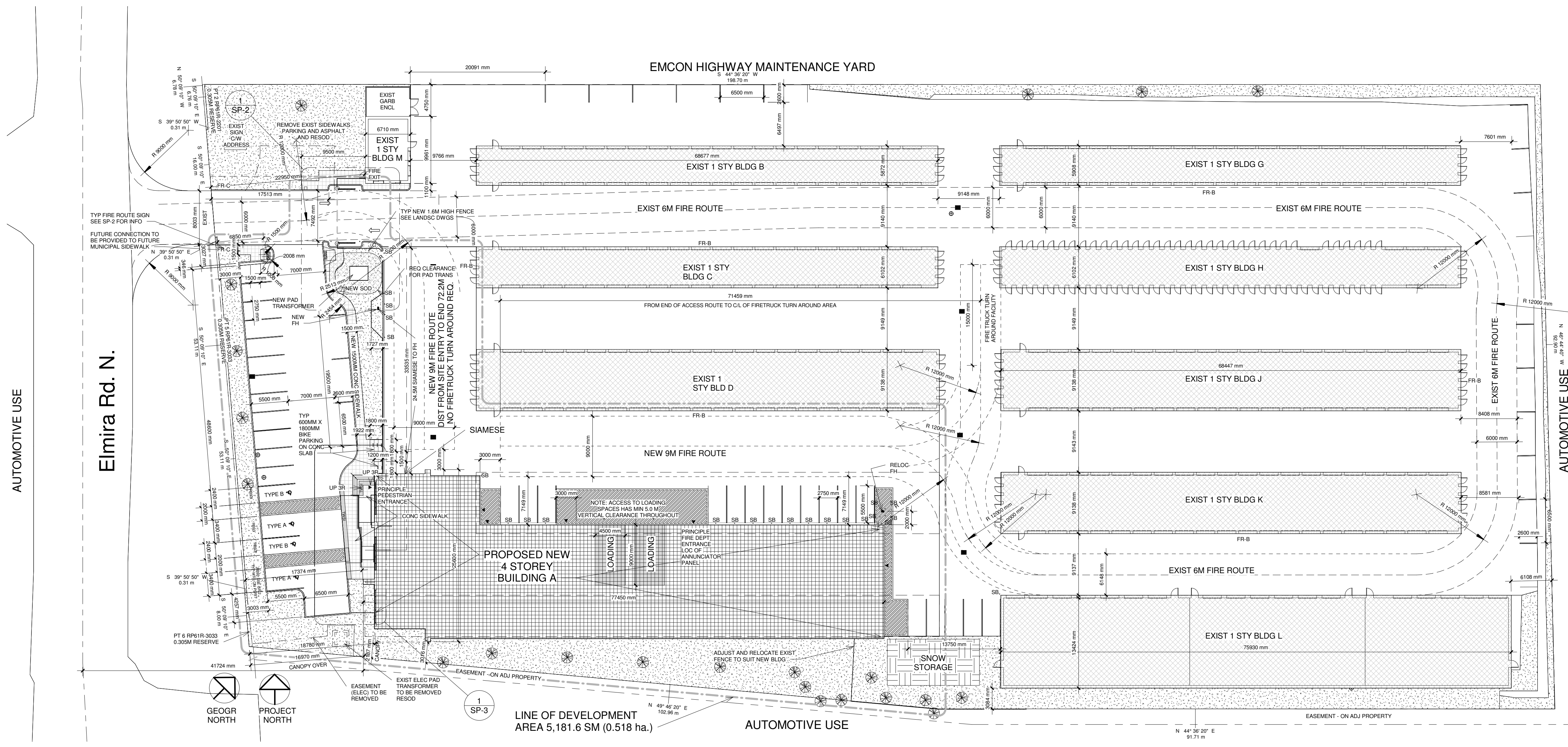

1 Bldg A Main Floor Plan  
1 : 350

ONTARIO ASSOCIATION OF ARCHITECTS  
OF ARCHITECTS  
KEVIN G. MANUEL  
LICENCE 4037

SP-1

**Kevin Manuel Architect Limited**

67 Painted Post Drive  
Scarborough \* Ontario  
MIH IT3 \* Tel.: 416-540-5667

No.	Date	Issued
5	Jun. 10, 2023	For SPA03 submission
6	Sep. 1, 2023	For SPA03 revisions submission
7	Sep. 13, 2023	For SPA03/CoA revisions

Revision Number	Revision Date	Revision Description
Revision Schedule		

This drawing is an instrument of service only. The copyright to this drawing belongs to the Consultant. This drawing may not be used by anyone for any purpose other than the intended original purpose for the original client unless authorized in writing by the Consultant. This drawing may not be reproduced in whole or in part in any manner, or stored in any form for reproduction without the written consent of the Consultant.

This drawing must not be scaled.

All persons relying on these drawings shall check and verify all dimensions, whether noted or implied, on site, and shall inform the consultant of any variation from the dimensions and/or the conditions prior to starting or continuing work.

If this drawing was created and/or transferred on electronic media to any other person, then that user should be aware that the drawing may have been altered after it was issued by the Consultant. The Consultant hereby declares that the only original of this drawing is the one contained in the Consultants files. The Consultant will accept no responsibility whatsoever for drawings which have been so transferred unless they match in every detail the original on file in the Consultants office.

This drawing may contain information which was provided, for information only to the Consultant, by others. The Consultant accepts no responsibility for the accuracy or completeness of this information. Should this information be determined to be critical to the performance of the work, the user is required to refer back to the original source of the information.

This drawing shall not be used for construction unless countersigned below by the Consultant

Approved for Construction

**Self Store New Building**  
595 Elmira Rd. N  
Guelph, Ontario

Site Plan

Project Number	31034
Date	15/11/21
Drawn By	TM
Checked By	KM
Scale	As indicated