

No.	DATE	REVISION
1	23.07.31	ISSUED FOR CLIENT REVIEW
2	23.08.21	REISSUED FOR CLIENT REVIEW
3	23.08.29	ISSUED FOR PERMIT

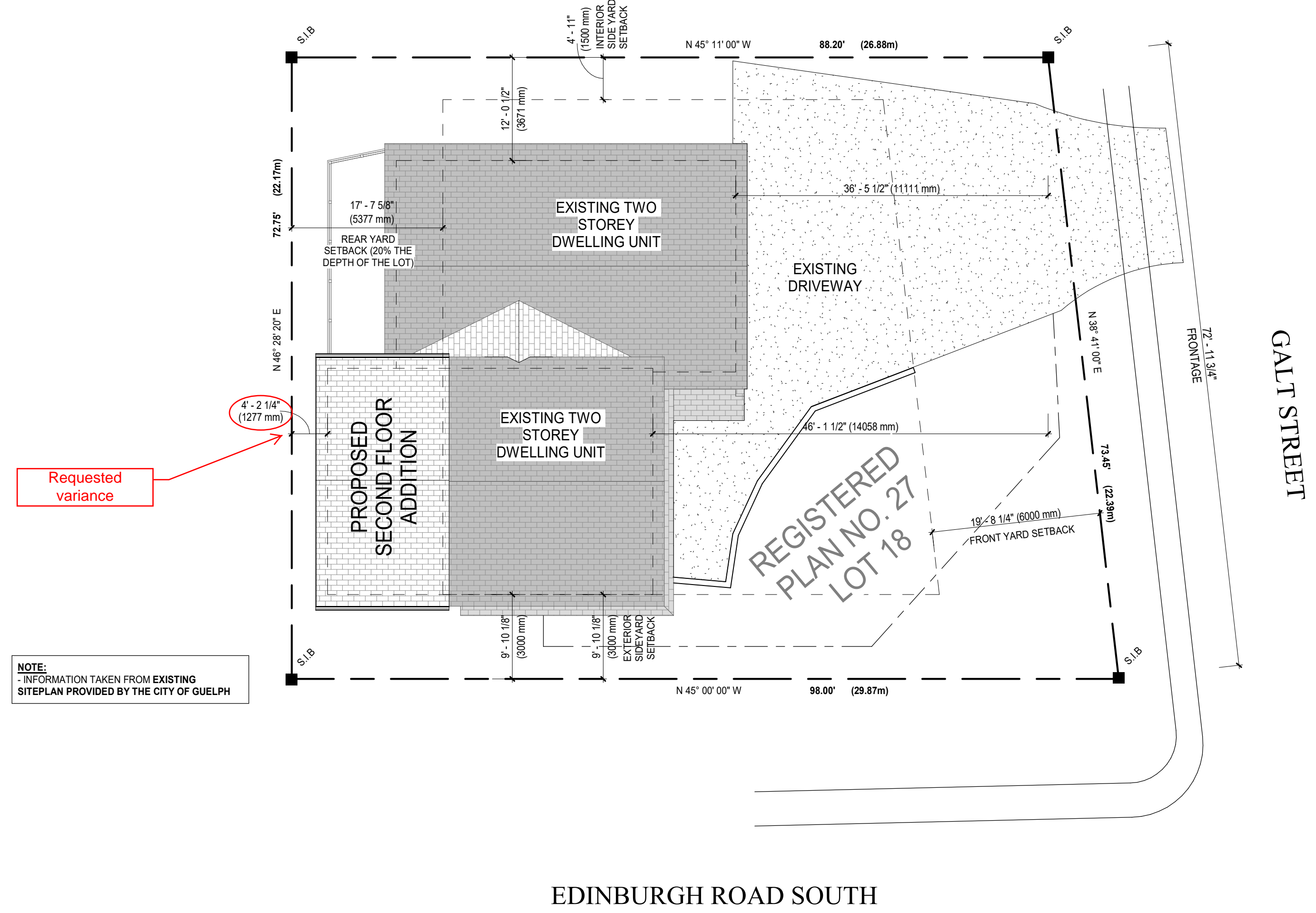

NOTE:
- INFORMATION TAKEN FROM EXISTING
SITEPLAN PROVIDED BY THE CITY OF GUELPH

Requested variance

1
SPL.0
PROPOSED SITE PLAN
3/28" = 1'-0"

EDINBURGH ROAD SOUTH

GALT STREET



TONY TEYMORY
PROPOSED SIDE AND
SECOND STOREY
ADDITION
48 EDINBURGH ROAD SOUTH,
GUELPH, ON. N1H 5N9

SITE PLAN

DRAWN BY: J. KELLY PROJECT No.: 23TC061

SP1.0