

114108
42 ARROW RD.
CITY OF GUELPH

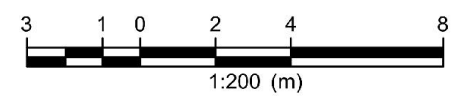

LEGEND



SCALE = 1:200
~~JANUARY 2016~~
AUGUST 2020

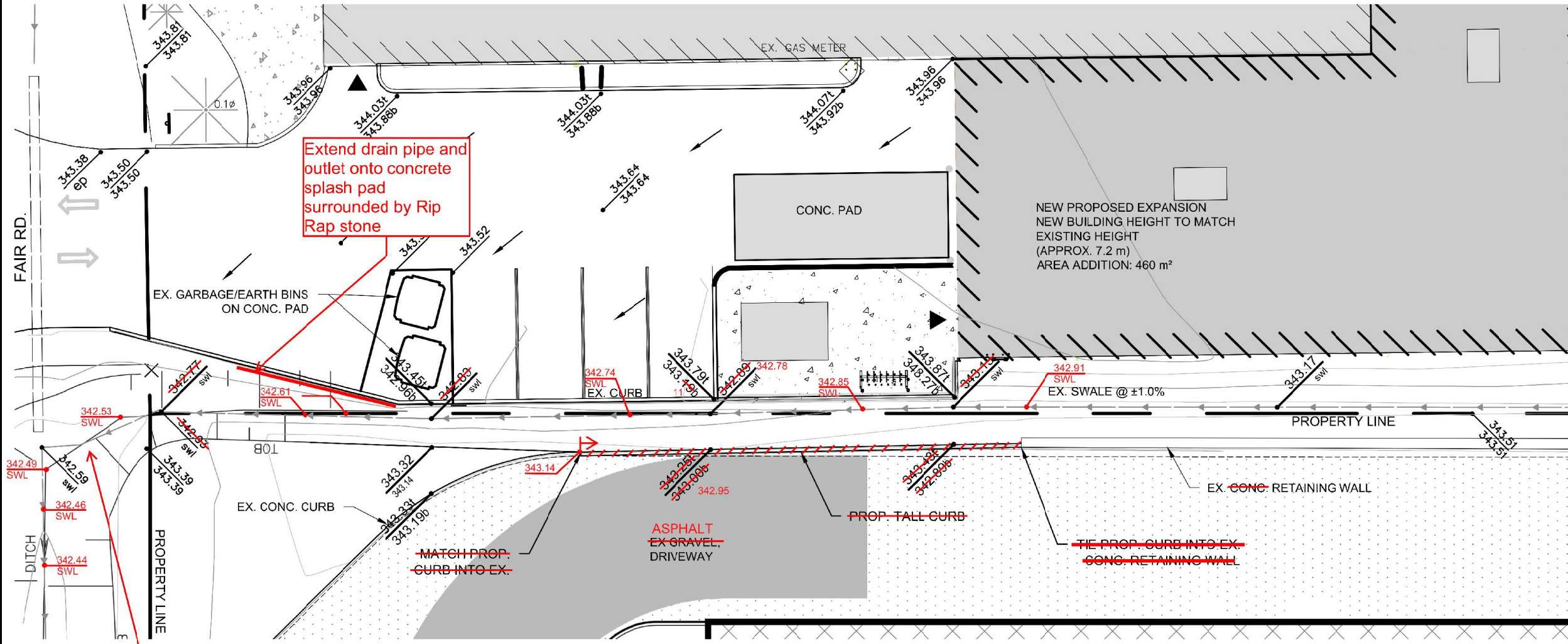

Extend drain pipe and outlet onto concrete splash pad surrounded by Rip Rap stone

Re grade swale to proposed grades and restore with Topsoil and sod. Slopes to be 3:1 where possible

Proposed cross section in areas w/o curb

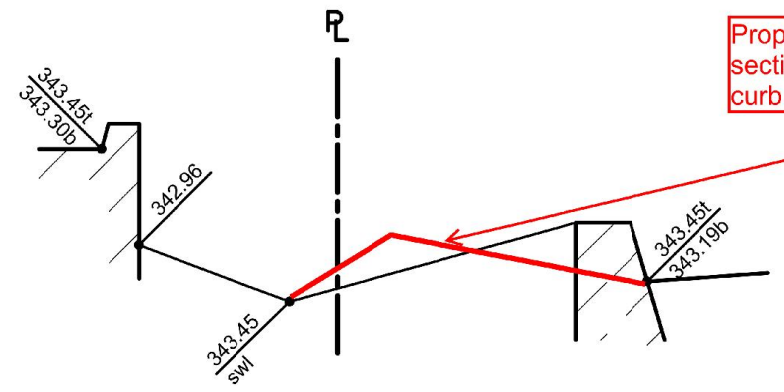

Proposed Remedial swale work
GMBP file: 114108
S Conway
2020-08-14
For Review Purposes

TBM #2
Spike in HP North Side of Fair Road
Opposite #42 Arrow Road
ELV=343.620

SOUTH/WEST SWALE
ALONG PROPERTY LINE

Figure No. 1

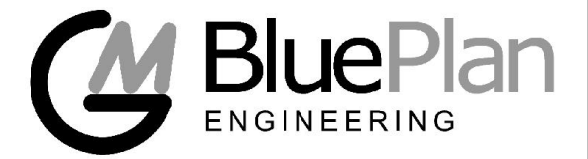

FILE:W:\Guelph\114-20\114108\Design Phase\Drawings\114108-GR.DWG LAYOUT:Layout2
LAST SAVED BY:EVanschip, 1/14/2016 11:23:54 AM PLOTTED BY:Eric Van Schip - GM BluePlan 1/15/2016 9:53:15 AM