

**NOTES:**

1. THIS PLAN MUST BE READ IN CONJUNCTION WITH THE APPROVED LOT GRADING PLAN.
2. LOT DIMENSIONS ARE AS SHOWN ON REGISTERED PLAN 61M-172 AND HAVE NOT BEEN VERIFIED BY SURVEY. PROPOSED BUILDING POSITIONED BY CALCULATION, NOT BY ACTUAL SURVEY.
3. THE POSITION OF ALL POLE LINES, CONDUITS, WATER MAINS, SEWERS AND OTHER UNDERGROUND AND OVERHEAD UTILITIES AND STRUCTURES IS NOT NECESSARILY SHOWN ON THIS PLAN, AND WHERE SHOWN, THE ACCURACY OF THE POSITION OF SUCH UTILITIES AND STRUCTURES IS NOT GUARANTEED. BEFORE STARTING WORK, THE CONTRACTOR SHALL INFORM HIMSELF OF THE EXACT LOCATION OF ALL SUCH UTILITIES AND STRUCTURES, AND SHALL ASSUME ALL LIABILITY FOR DAMAGE TO THEM.
4. ELEVATIONS SHOWN HEREON ARE IN ACCORDANCE WITH THE LOT GRADING PLAN FOR REGISTERED PLAN 61M-172 AND ARE PROPOSED.

- 300.00 DENOTES PROPOSED GRADE BY BSR&D
- 300.00 DENOTES SPECIFIED HOUSE GRADE
- 300.00 DENOTES PROPOSED ELEVATION
- DENOTES DIRECTION OF DRAINAGE
- DENOTES IRON PIN TO BE SET ON SITE

**SKETCH**

PREPARED FOR BUILDING PERMIT APPLICATION

SCALE 1 : 250



METRIC: DISTANCES SHOWN ON THIS PLAN ARE IN METRES AND CAN BE CONVERTED TO FEET BY DIVIDING BY 0.3048

CAUTION: THIS IS NOT A PLAN OF SURVEY AND SHALL NOT BE USED EXCEPT FOR THE PURPOSE INDICATED IN THE TITLE BLOCK.

- T.F. DENOTES TOP OF FOUNDATION
- U.S.F. DENOTES UNDERSIDE OF FOOTINGS
- B.F. DENOTES BASEMENT FLOOR

**City of Guelph**

**NOTE:**

T.F. TO GARAGE FLOOR = 0.43 (17")

T.F. TO U.S.F. = 2.90 (114")

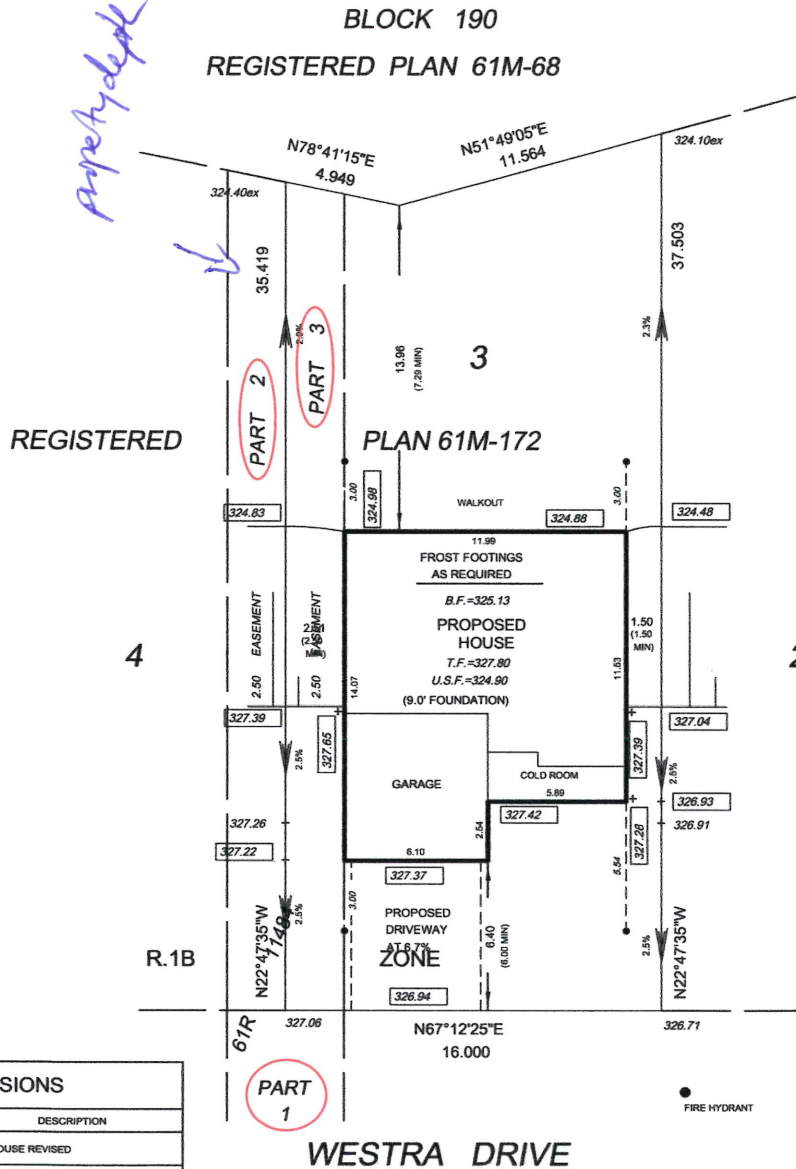

REVISIONS			
NO.	DATE	BY	DESCRIPTION
1	AUG. 21/12	DM	HOUSE REVISED

THIS SKETCH WAS PREPARED FOR FUSION HOMES AND THE UNDERSIGNED ACCEPTS NO RESPONSIBILITY FOR USE BY OTHER PARTIES.

KERRY F. HILLIS  
ONTARIO LAND SURVEYOR

© COPYRIGHT 2012: REPRODUCTION, DISTRIBUTION OR ALTERATION OF THIS PLAN, IN WHOLE OR IN PART, WITHOUT THE WRITTEN PERMISSION OF BLACK, SHOEMAKER, ROBINSON & DONALDSON LIMITED IS STRICTLY PROHIBITED.

BLACK, SHOEMAKER, ROBINSON & DONALDSON LIMITED

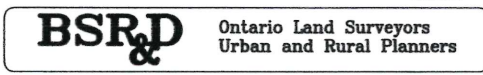

351 Speedvale Avenue West  
Guelph, Ontario N1H1C6  
FAX: (519) 822-1220  
TEL: (519) 822-4031

DATE: JULY 19, 2012      DM      PROJECT 11-9023-41