

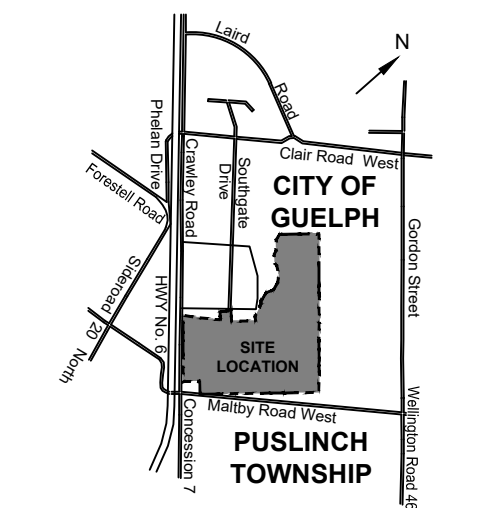

I/R	DATE	DESCRIPTION
6		
5	2023-04-28	ISSUED FOR PHASE 1 SPA
4	2023-03-02	ISSUED FOR CLIENT REVIEW
3	2023-02-10	ISSUED FOR CLIENT REVIEW
2	2022-12-20	ISSUED FOR PHASE 1 SPA
1	2022-10-26	ISSUED FOR DRAFT PLAN APPROVAL



**LEGEND**

- PROPERTY LINE
- 30.0m WETLAND BUFFER
- EXISTING WETLAND
- EXISTING WOODLAND
- PROPOSED PERENNIAL PLANTING
- PROPOSED LOW MAINTENANCE ECO LAWN SEED
- PROPOSED TEMPORARY SEED (NATIVE PRAIRIE MEADOW MIX)
- EXISTING TREE PROPOSED TO BE RETAINED
- PROPOSED CONIFEROUS TREE
- PROPOSED DECIDUOUS TREE
- FUTURE 14.0m BERMED AND LANDSCAPED BUFFER
- LIMIT OF 14.0m BERMED AND LANDSCAPED BUFFER
- PROPOSED TREE PROTECTION FENCING REFER TO ARBORIST REPORT FOR DETAILS
- PROPOSED LIMIT OF PHASE 1 DEVELOPMENT
- PROPOSED LIGHT POLES REFER TO ELECTRICAL DRAWINGS FOR DETAILS

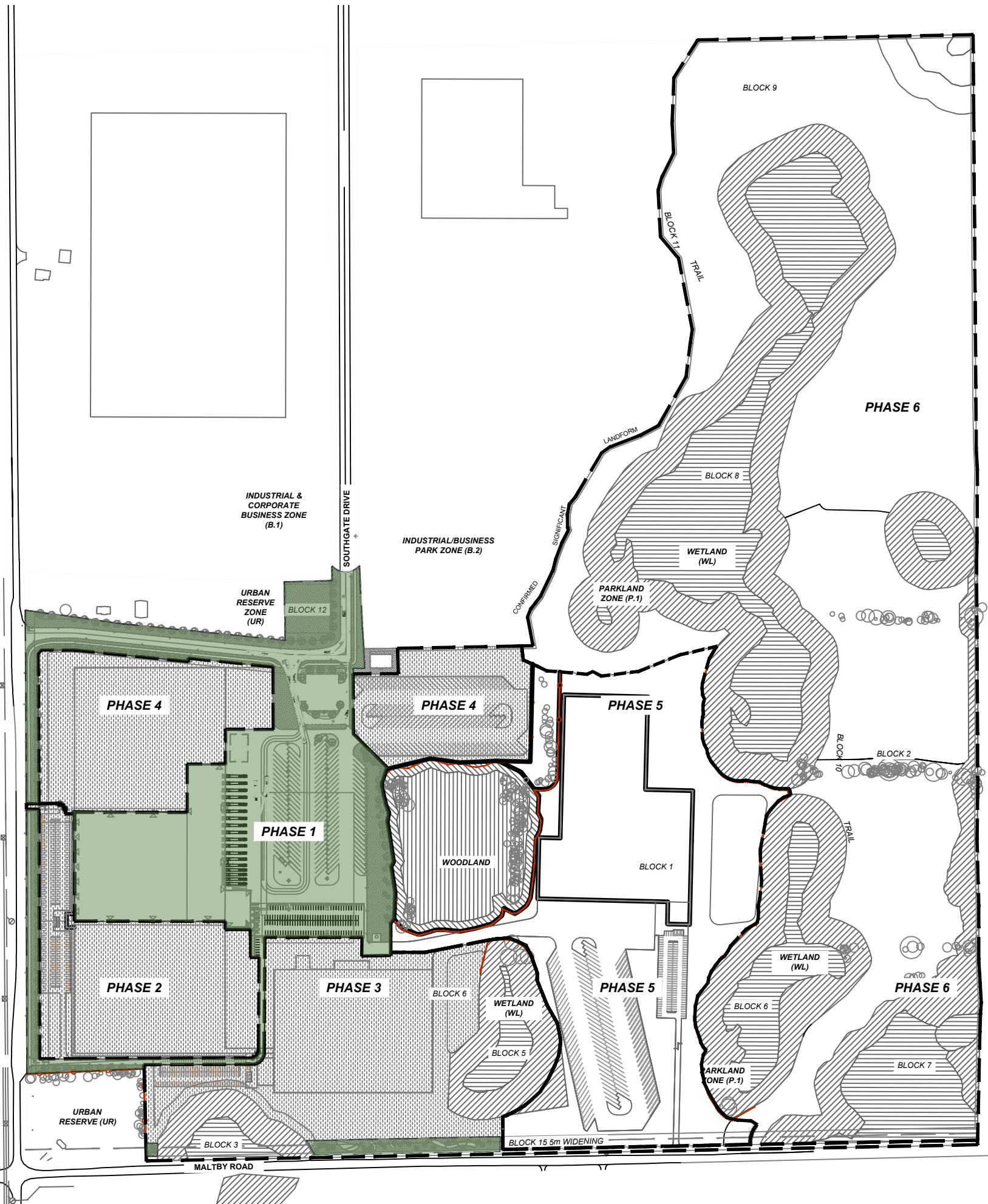

**OVERALL PHASING PLAN**

## THE KING'S HIGHWAY 6 HANLON EXPRESSWAY

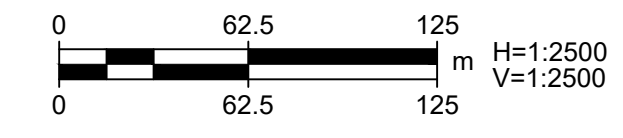
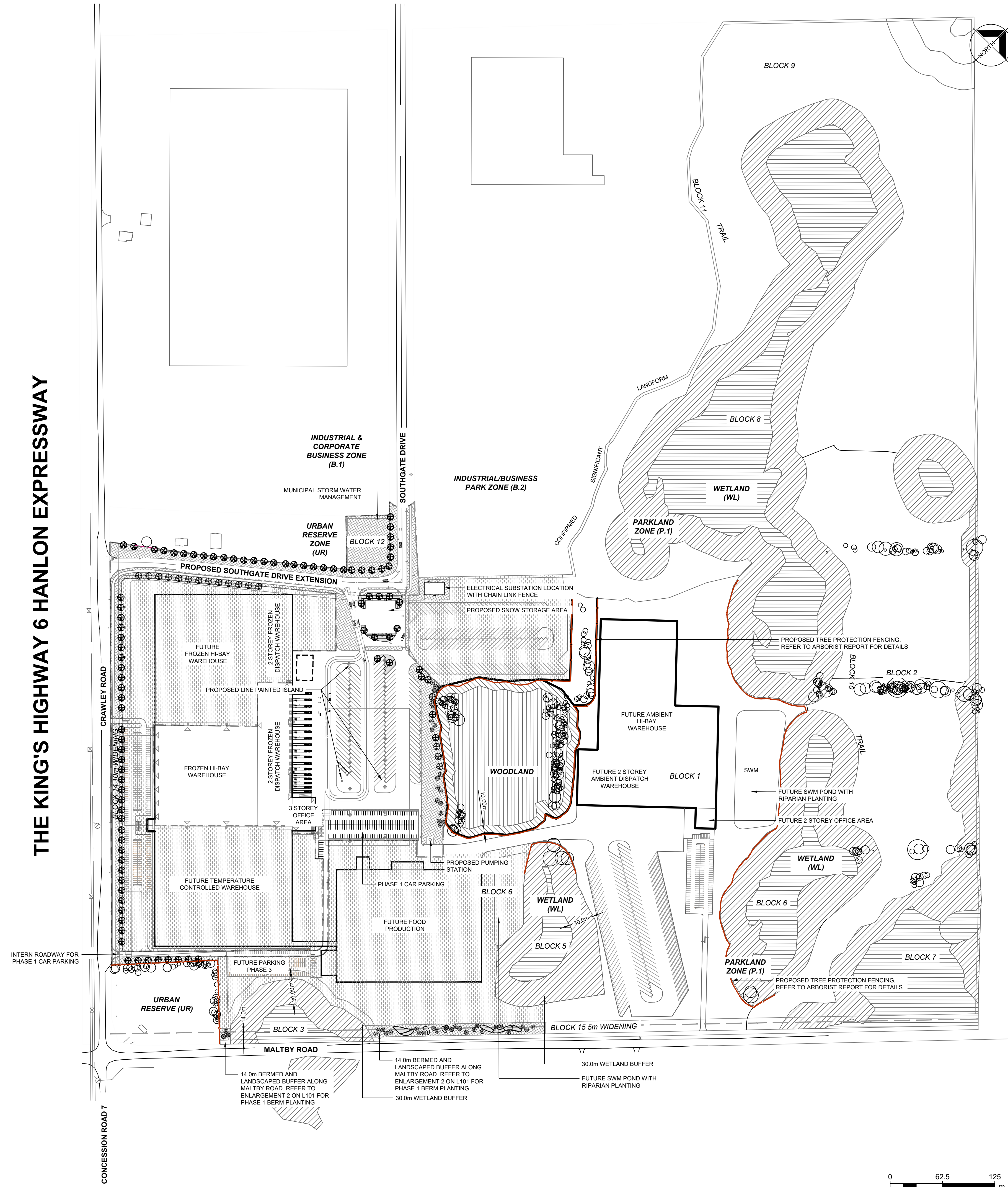

This drawing has been prepared for the use of AECOM's client and may not be used, reproduced or relied upon by third parties, except as agreed by AECOM and its client, as required by law or for use by governmental reviewing agencies. AECOM accepts no responsibility, and denies any liability, whatsoever, to any party that modifies this drawing without AECOM's express written consent. Do not scale. All measurements must be obtained from scaled dimensions.

LEGEND	
	PROPERTY LINE
	30.0m WETLAND BUFFER
	EXISTING WOODLAND
	PROPOSED PERENNIAL PLANTING (REFER TO PLANT LIST & PLANTING ENLARGEMENT)
	PROPOSED LOW MAINTENANCE ECO LAWN SEED
	PROPOSED TEMPORARY SEED (NATIVE PRAIRIE MEADOW MIX)
	EXISTING TREE PROPOSED TO BE RETAINED
	PROPOSED CONIFEROUS TREE
	PROPOSED DECIDUOUS TREE
	PROPOSED TREE PROTECTION FENCING REFER TO ARBORIST REPORT FOR DETAILS
	PROPOSED LIMIT OF PHASE 1 DEVELOPMENT
	PROPOSED LIGHT POLES REFER TO ELECTRICAL DRAWINGS FOR DETAILS
	PROPOSED HYDRANT REFER TO CIVIL DRAWINGS FOR DETAILS
	PROPOSED FENCE
	PROPOSED MODULOC FENCE

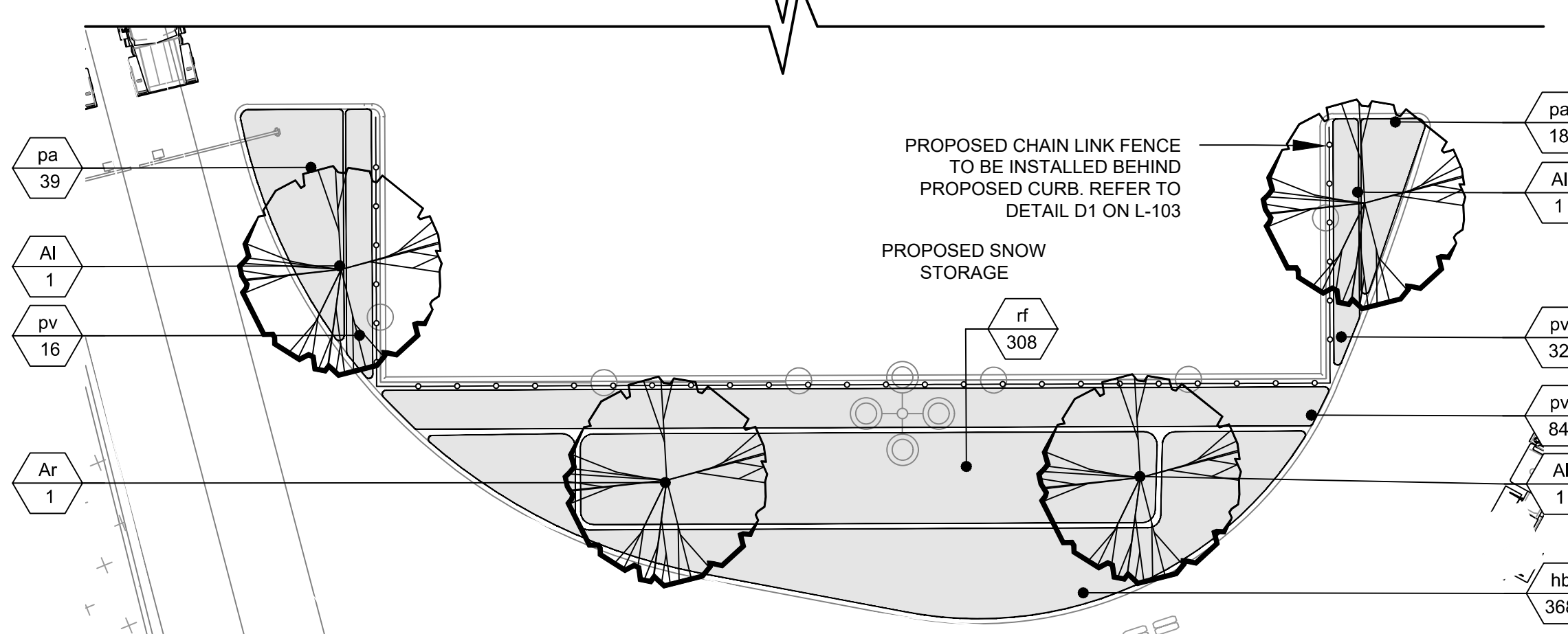
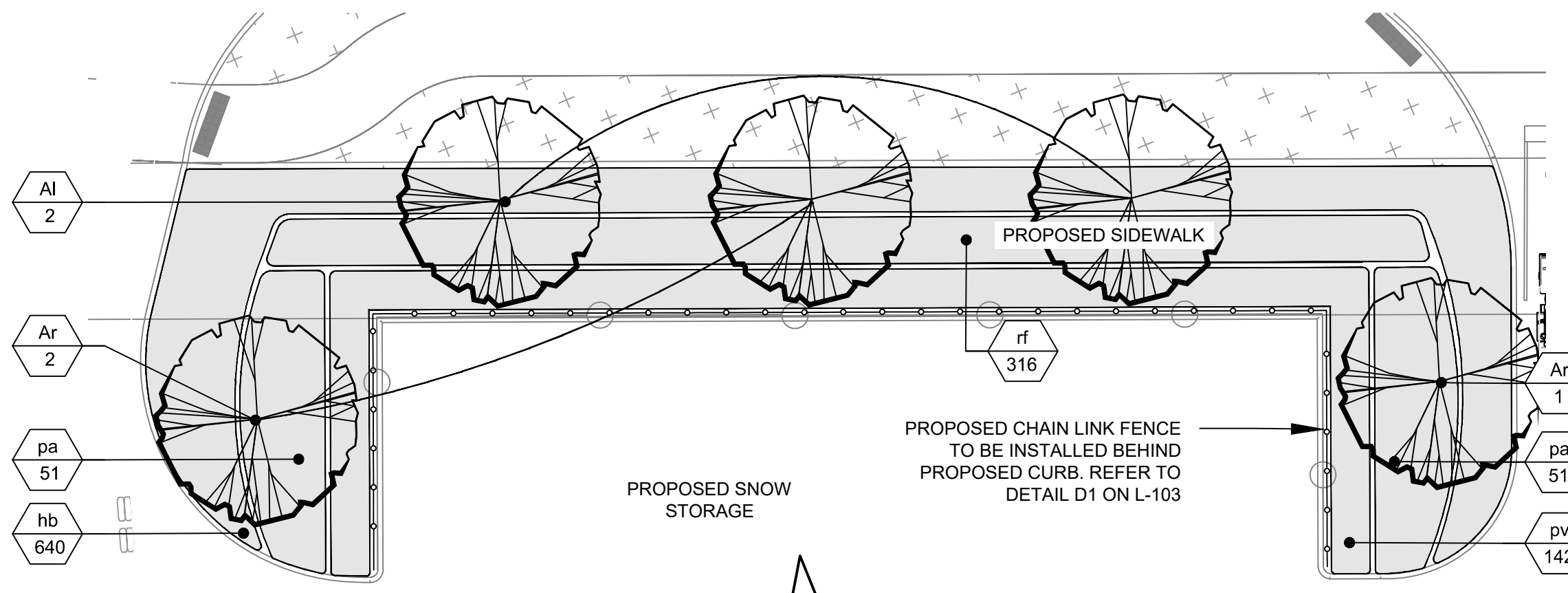

**E1** SCREENED SNOW REMOVAL EQUIPMENT AND GARBAGE AREA ENLARGEMENT  
L-101 1:200

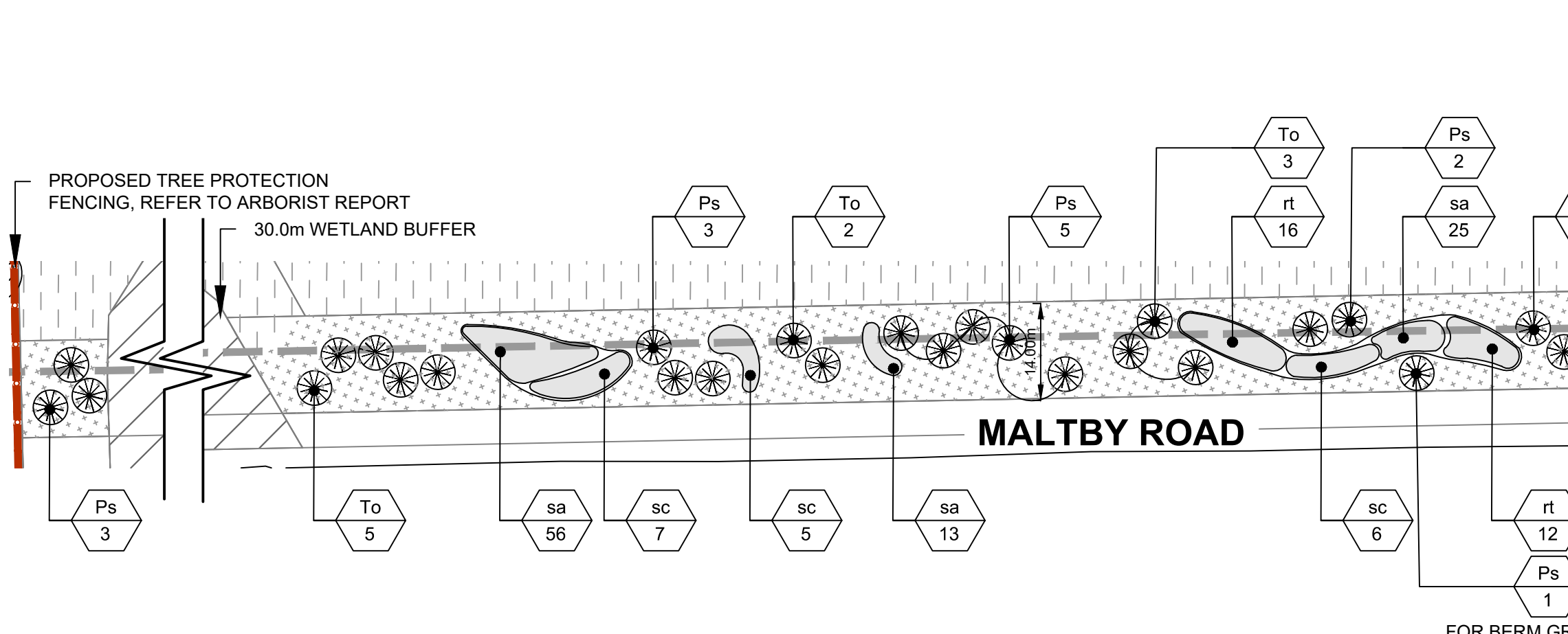

**E2** LANDSCAPED BERM ALONG MALTBY ROAD  
L-101 1:750

**THE KING'S HIGHWAY 6 HANLON EXPRESSWAY CRAWLEY ROAD**

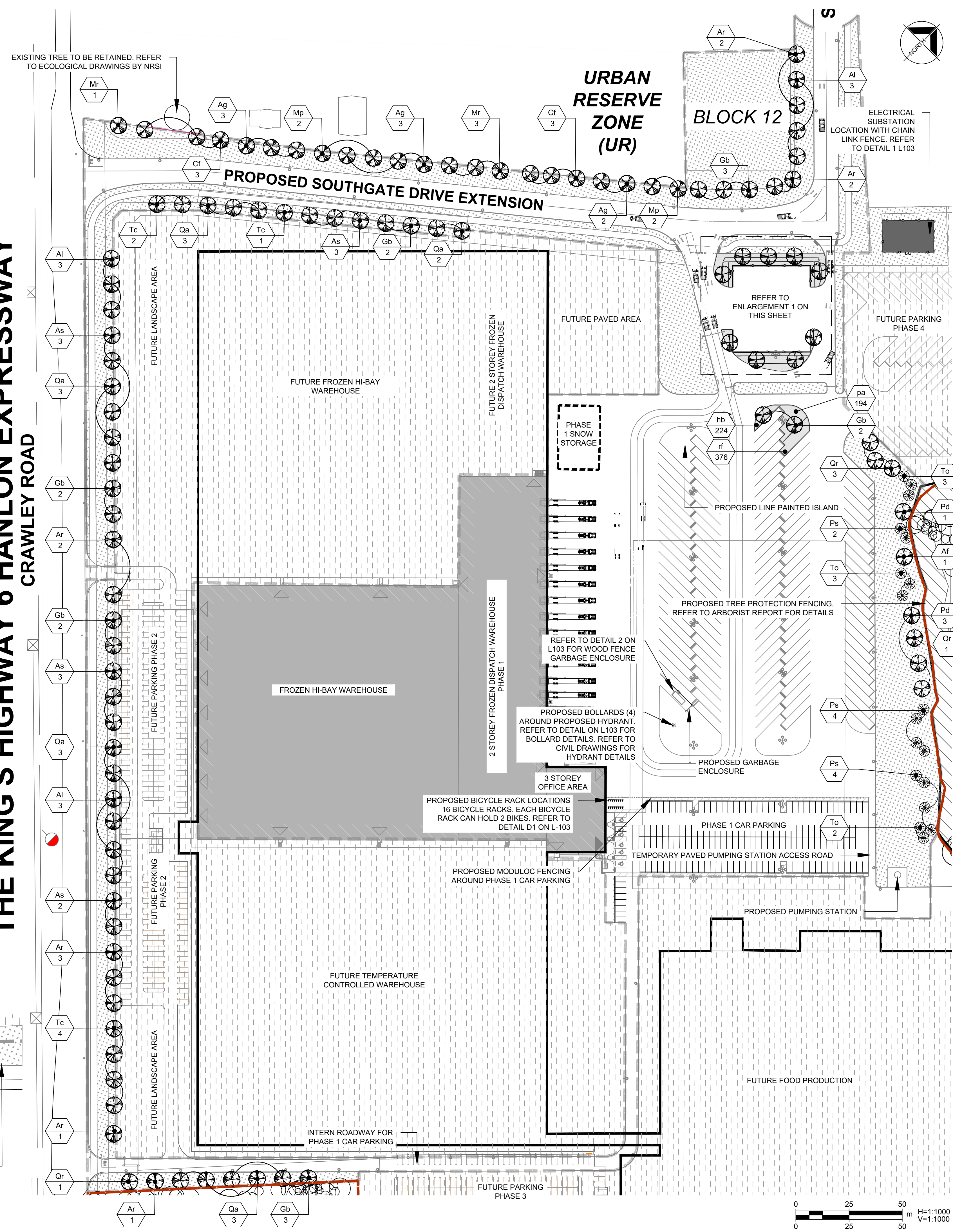

**AECOM**

PROJECT  
NEWCOLD GUELPH - T001  
GUELPH, ONTARIO

CLIENT

CONSULTANT  
AECOM Canada Ltd.  
50 Sportsworld Crossing Road, Suite 290  
Kitchener, Ontario, N2P 0A4  
519 650 5313 tel 519 650 3424 fax  
www.aecom.com

NOTE:  
IT IS THE RESPONSIBILITY OF THE CONTRACTORS TO INFORM THEMSELVES OF THE EXACT LOCATION OF AND ASSUME ALL LIABILITY FOR DAMAGE TO ALL UTILITIES, SERVICES AND STRUCTURES WHETHER ABOVE GROUND OR BELOW GRADE BEFORE COMMENCING THE WORK. SUCH INFORMATION IS NOT NECESSARILY SHOWN ON THE DRAWING, AND WHERE SHOWN, THE ACCURACY CANNOT BE GUARANTEED.  
WITH THE SOLE EXCEPTION OF THE BENCHMARKS SPECIFICALLY DESCRIBED FOR THIS PROJECT, NO ELEVATION INDICATED OR ASSUMED HEREON IS TO BE USED AS A REFERENCE ELEVATION FOR ANY PURPOSE.  
CULVERT BEDDING PER RPD STD DWG 5-2-18

REGISTRATION

ISSUE/REVISION

I/R	DATE	DESCRIPTION
6		
5	2023-04-28	ISSUED FOR PHASE 1 SPA
4	2023-03-02	ISSUED FOR CLIENT REVIEW
3	2023-02-10	ISSUED FOR CLIENT REVIEW
2	2022-12-20	ISSUED FOR PHASE 1 SPA
1	2022-10-26	ISSUED FOR DRAFT PLAN APPROVAL

KEY PLAN

PROJECT NUMBER  
60682143

SHEET TITLE  
LANDSCAPE SITE PLAN  
PHASE 1

SHEET NUMBER  
L101

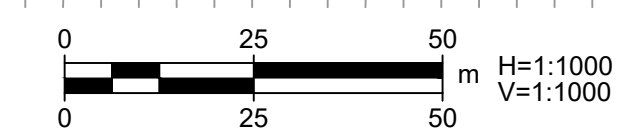

ARCH D 24" x 36" Approved RB Checked RB Designer: AH Project Management Initials:

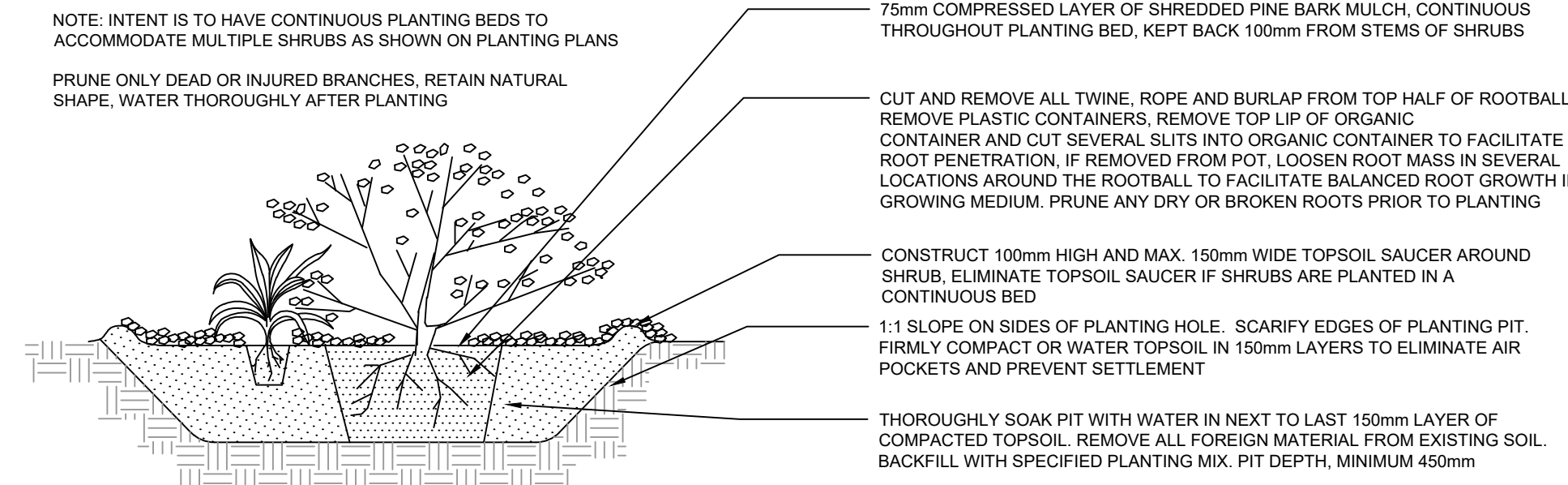
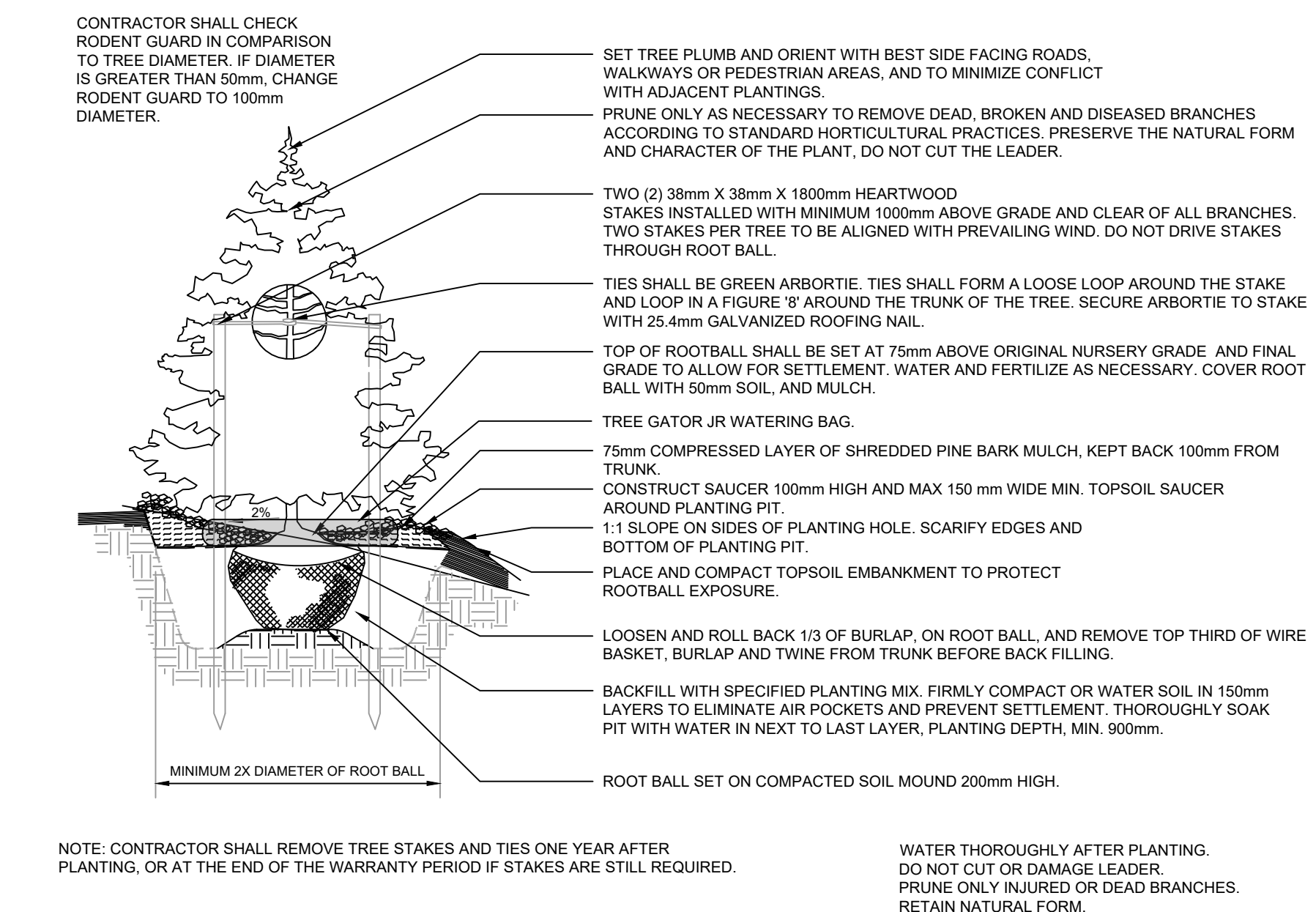
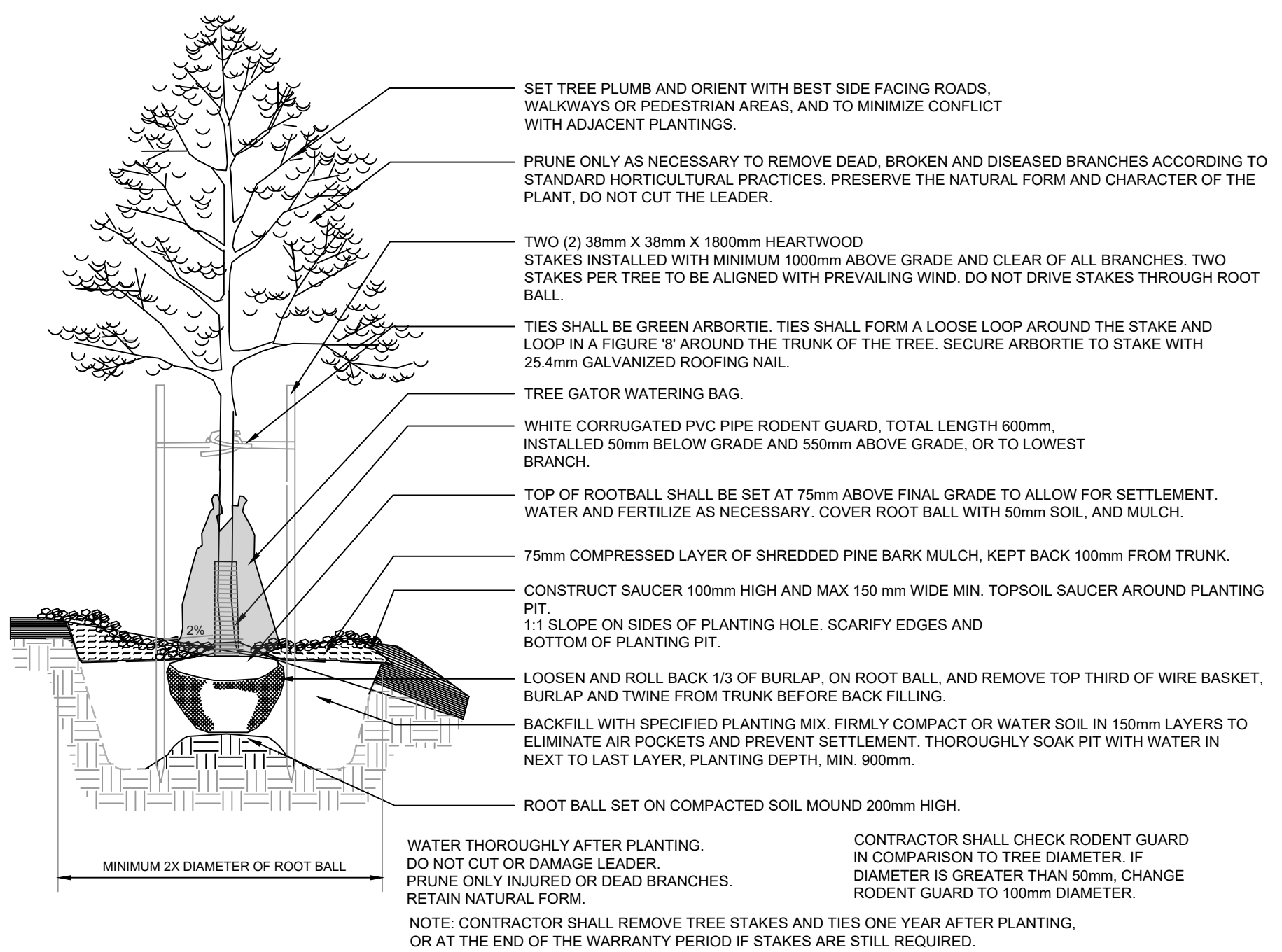

**D1 DECIDUOUS TREE PLANTING**  
 L-102 1:25

**D2 CONIFEROUS TREE PLANTING**  
 L-102 1:25

**D3 SHRUB PLANTING**  
 L-102 1:25

PLANT LIST						
KEY	QTY	BOTANICAL NAME	COMMON NAME	SIZE	CONDITION	SPACING
<b>DECIDUOUS TREE</b>						
Ag	8	Acer ginnala	Amur Maple	50mm cal.	WB	As Shown
Af	1	Acer x freemanii	Freeman Maple	50mm cal.	WB	As Shown
Ar	15	Acer rubrum	Red Maple	50mm cal.	WB	As Shown
As	9	Acer saccharinum	Silver Maple	50mm cal.	WB	As Shown
Al	14	Amelanchier laevis	Smooth Serviceberry	50mm cal.	WB	As Shown
Cf	6	Cornus florida 'Rubra'	Pink Flowering Dogwood (Tree Form)	50mm cal.	WB	As Shown
Pd	4	Populus deltoides	Eastern Cottonwood	50mm cal.	WB	As Shown
Gb	14	Ginkgo biloba	Ginkgo	50mm cal.	WB	As Shown
Mp	4	Malus 'Pink Spires'	Pink Spires Crabapple	50mm cal.	WB	As Shown
Mr	4	Malus 'Royalty'	Royalty Crabapple	50mm cal.	WB	As Shown
Qa	14	Quercus alba	White Oak	50mm cal.	WB	As Shown
Qr	5	Quercus rubra	Red Oak	50mm cal.	WB	As Shown
Tc	7	Tilia cordata	Littleleaf Linden	50mm cal.	WB	As Shown
<b>CONIFEROUS TREE</b>						
To	22	Thuja occidentalis	Eastern White Cedar	2.0m ht.	WB	As Shown
Ps	24	Pinus strobus	Eastern White Pine	2.0m ht.	WB	As Shown
<b>SHRUBS &amp; PERENNIALS</b>						
hb	1232	Hemerocallis 'Bonanza'	Bonanza Daylily	1 gal.	Potted	50cm O.C.
pa	353	Perovskia atriplicifolia	Russian Sage	1 gal.	Potted	80cm O.C.
rf	1000	Rudbeckia fulgida 'Goldstrum'	Black-Eyed Susan	1 gal.	Potted	50cm O.C.
rt	28	Rhus typhina	Staghorn Sumac	80cm ht.	Potted	2.0m O.C.
sa	94	Symphoricarpos albus	Snowberry	80cm ht.	Potted	1.25m O.C.
sc	18	Sambucus nigra ssp. Canadensis	Elderberry	80cm ht.	Potted	2.5m O.C.
<b>GRASSES</b>						
pv	274	Panicum virgatum 'Heavy Metal'	Heavy Metal Switch Grass	1 gal.	Potted	80cm O.C.

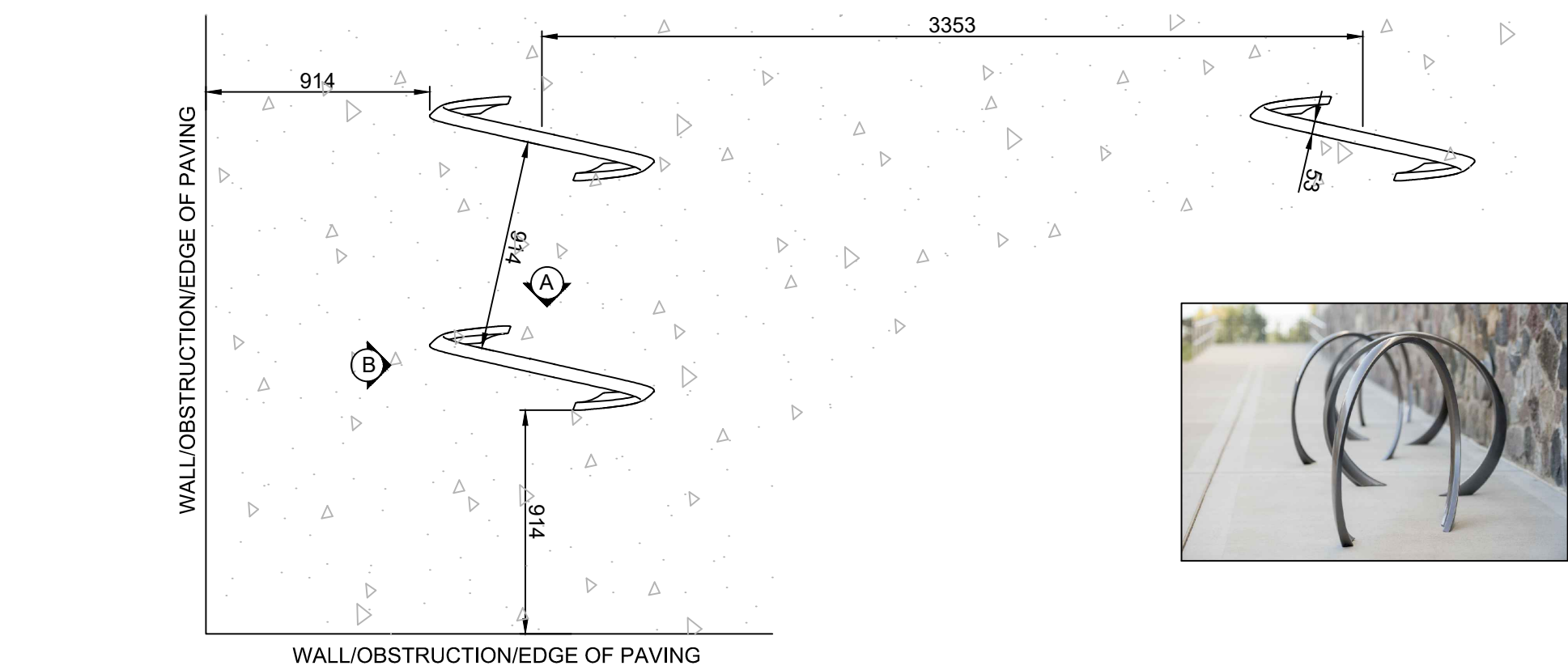

**D3 LOOP BIKE RACK**  
 L102 1:25

**GENERAL NOTES:**

- THESE DRAWINGS SHALL NOT BE USED FOR CONSTRUCTION UNLESS STAMPED AND SIGNED BY THE LANDSCAPE ARCHITECT.
- ANY AMBIGUITY IN THE DRAWINGS, SPECIFICATIONS OR DETAILS IS TO BE REPORTED TO THE CONTRACT ADMINISTRATOR FOR DIRECTION. DO NOT PROCEED IN UNCERTAINTY.
- DRAWINGS MAY BE SCALED FOR APPROPRIATE LAYOUT ONLY. ALL MEASUREMENTS IN METRIC. ALL LAYOUT, INCLUDING PLANTING, TO BE STAKED BY THE CONTRACTOR AND APPROVED BY THE CONTRACT ADMINISTRATOR PRIOR TO THE COMMENCEMENT OF WORK.
- THE CONTRACTOR IS TO TAKE NECESSARY PRECAUTION TO PROTECT ALL EXISTING SITE FEATURES UNLESS SPECIFIED FOR DEMOLITION. THIS INCLUDES ALL SURVEY BARS, STAKES AND MONUMENTS. MAKE GOOD ANY DAMAGE.
- UPON COMPLETION OF WORK EACH DAY, REMOVE ALL DEBRIS, GARBAGE AND SURPLUS MATERIALS FROM THE SITE. KEEP THE SITE CLEAN AND USABLE AT ALL TIMES.
- ALL LANDSCAPE WORKMANSHIP AND MATERIALS, INCLUDING PLANTS, TO BE GUARANTEED FOR TWO FULL YEARS FOLLOWING FINAL ACCEPTANCE OF THE PROJECT. ALL WORKMANSHIP TO THE STANDARDS OF LANDSCAPE ONTARIO.
- AT THE TIME OF FINAL INSPECTION, ALL PLANTS SHALL BE IN A HEALTHY, VIGOROUS GROWING CONDITION, PLANTED IN FULL ACCORDANCE WITH DRAWINGS AND CONDITIONS.
- ANY CHANGES TO THIS ACCEPTED PLAN MUST BE REVIEWED AND APPROVED BY THE CONTRACT ADMINISTRATOR.
- WOODLAND COMPENSATION AREA, BUFFERS AND LINKAGE AREA PLANTING DETAILS TO BE PROVIDED BY NATURAL RESOURCE SOLUTIONS INC. (NRSI).

**PLANTING NOTES**

- PLANT MATERIALS SPECIFIED FOR THIS PROJECT WILL CONFORM TO THE CANADIAN NURSERY LANDSCAPE ASSOCIATION (CNLA) FOR SIZE, VARIETY AND CONDITION AS INDICATED ON THE PLANT LIST SHOWN ON THIS SHEET. ANY PLANT MATERIALS WHICH DO NOT CONFORM WILL BE PROMPTLY REMOVED FROM THE SITE AND REPLACED BY THE CONTRACTOR AT NO ADDITIONAL COST.
- THE CONTRACT ADMINISTRATOR IS TO BE CONTACTED FOR INSPECTION AND WRITTEN APPROVAL PRIOR TO ANY PLANT MATERIAL INSTALLATION. THE CONTRACT ADMINISTRATOR RESERVES THE RIGHT TO REJECT ANY PLANT MATERIALS THAT HAVE NOT BEEN INSPECTED AND APPROVED.
- ANY PLANT MATERIAL THAT IS REJECTED BY THE CONTRACT ADMINISTRATOR WILL BE

- PROMPTLY REMOVED FROM THE SITE AND REPLACED WITH MATERIAL OF ACCEPTABLE QUALITY AT NO ADDITIONAL COST TO THE PROJECT.
- ONLY REMOVE DEAD OR DAMAGED BRANCHES ON TREES AND SHRUBS. ALL PRUNING SHALL BE PERFORMED IN ACCORDANCE WITH STANDARD HORTICULTURAL PRACTICES AND APPROPRIATE TIMING FOR EACH SPECIES.
- PLANTING LAYOUT TO BE DETERMINED ON SITE AT DIRECTION OF THE CONTRACT ADMINISTRATOR. FIELD ADJUSTMENTS TO GENERAL PLANT LOCATIONS INDICATED ON THE PLAN MAY BE NECESSARY TO RESPOND TO SITE CONDITIONS.
- ANY DISCREPANCIES BETWEEN QUANTITIES SHOWN AND THE PLANT LIST SHALL BE REPORTED TO THE CONTRACT ADMINISTRATOR FOR DIRECTION.
- ANY SUBSTITUTIONS OF PLANT MATERIALS REQUIRE THE PRIOR WRITTEN PERMISSION OF THE CONTRACT ADMINISTRATOR.
- TREES AND SHRUBS ARE TO BE PLANTED AND STAKED IN ACCORDANCE WITH TYPICAL PLANTING DETAILS. CONTRACTOR TO REMOVE ALL STAKES AND TIES FROM THE SITE AT THE END OF THE TWO-YEAR WARRANTY PERIOD.
- PLANTS ARE NOT TO BE INSTALLED OR TRANSPLANTED DURING EXTREME HEAT, DROUGHT, OR OTHER UNDESIRABLE CONDITIONS. THE CONTRACTOR IS NOT TO PROCEED IN UNCERTAINTY. CONTACT CONTRACT ADMINISTRATOR FOR DIRECTION.
- DO NOT PLANT IN DRAINAGE SWALES, WHERE PROPOSED PLANTING LOCATIONS CONFLICT WITH CONSTRUCTED SWALES, CONTACT CONTRACT ADMINISTRATOR FOR DIRECTION.
- ALL PLANT MATERIALS WILL BE PLANTED IN SOIL NATIVE TO THE SITE. IF ADDITIONAL TOPSOIL IS NECESSARY FOR COMPLIANCE WITH THESE SPECIFICATIONS, IT MUST BE APPROVED BY THE CONTRACT ADMINISTRATOR PRIOR TO APPLICATION.
- ALL TOPSOIL IS TO BE STOCKPILED SEPARATELY FROM SUBSOIL DURING THE EXCAVATION PERIOD.
- ALL SUBSOIL COMPACTED DURING CONSTRUCTION ACTIVITIES IS TO BE SCARIFIED TO THE SATISFACTION OF THE CONTRACT ADMINISTRATOR PRIOR TO PLACEMENT OF TOPSOIL.
- SHREDDED PINE BARK MULCH SHALL BE SPREAD UNIFORMLY AROUND BASE OF TREES AND SHRUBS TO A DEPTH OF 100mm AND A RADIUS OF 150mm FROM TRUNK(S) TO EXTENT OF PLANTING PIT. DO NOT PLACE MULCH IN DIRECT CONTACT WITH TRUNKS.
- SHRUBS TO BE PLANTED IN A CONTINUOUS PLANTING BED WITH CONTINUOUS MULCH.
- THE CONTRACTOR IS RESPONSIBLE FOR MAKING ARRANGEMENTS FOR PLANT MATERIAL TO BE MAINTAINED IN A HEALTHY STATE FOR THE DURATION OF THE WARRANTY PERIOD AND FOR ALL MAINTENANCE AND REPLACEMENT OF DEAD PLANT MATERIALS DURING THE WARRANTY PERIOD UNTIL ACCEPTABLE BY THE CONTRACT ADMINISTRATOR AND THE CITY OF GUELPH.
- ALL AREAS OF DISTURBED SOIL MUST BE STABILIZED WITH EROSION CONTROL MEASURES AND/OR SEEDED WITH NATIVE GROUND COVER SEED MIX IMMEDIATELY UPON COMPLETION OF

- WORK. PLEASE PROVIDE EROSION CONTROL MATTING/BANKETS WITH FULLY BIODEGRADABLE, WOVEN NETTING BE USED TO PREVENT WILDLIFE ENTRAPMENT.
- THE CONTRACTOR IS TO REVIEW WITH CONTRACT ADMINISTRATOR ANY MAINTENANCE REQUIREMENTS NECESSARY FOR WARRANTY PURPOSES.
- THE CITY OF GUELPH RESERVES THE RIGHT TO EXTEND THE CONTRACTOR'S WARRANTY RESPONSIBILITIES FOR AN ADDITIONAL YEAR IF, AT THE END OF THE INITIAL WARRANTY PERIOD LEAF DEVELOPMENT AND GROWTH IS NOT SUFFICIENT TO ENSURE FUTURE SURVIVAL AS DETERMINED BY CONTRACT ADMINISTRATOR.
- A MINIMUM OF TWO YEARS OF MONITORING FOR PLANT ESTABLISHMENT IS REQUESTED. ALL DEAD AND DYING PLANTS WOULD NEED TO BE REPLACED AT THE END OF THE TWO-YEAR MONITORING.
- LOCATE AND VERIFY THE EXISTENCE OF ALL UTILITIES PRIOR TO STARTING PLANTING OPERATIONS
- ALL PLANTS SHALL BE INSTALLED AS PER CONTRACT SPECIFICATIONS AND CITY OF GUELPH STANDARD DETAILS

**SEEDING NOTES**

- THE CONTRACTOR IS TO ENSURE COVERAGE AND SEED MIX GERMINATION.
- SEED APPLICATION TO BE APPLIED IN A CONSISTENT AND THOROUGH FASHION COVERING ENTIRE SITE.
- SEED SLOPES OF 3:1 OR GREATER TO BE APPLIED IN COMBINATION WITH FLEX TERRA HIGH PERFORMANCE-FLEXIBLE GROWTH MEDIUM (HP-FGM) OR APPROVED EQUIVALENT.
- SEED MIX AND RATES AS NOTED ON THIS SHEET. FOLLOW THE MANUFACTURER'S RECOMMENDATIONS AND INSTRUCTIONS FOR SEED METHOD(S).
- SEEDED AREAS WILL BE ACCEPTED PROVIDED THAT SEED IS PROPERLY ESTABLISHED AT 30, 60, AND 90-DAY PERIODS FOLLOWING SEED AND COVER INSTALLATION. SEED WILL BE INSPECTED BY THE CONTRACT ADMINISTRATOR AND/OR THE LANDSCAPE ARCHITECT USING THE SEEDING AND COVER QUALITY ASSURANCE VISUAL INSPECTION FIELD GUIDE ALONG WITH OPSS, PROV 804 TO ENSURE COMPLIANCE.
- CONTRACT ADMINISTRATOR TO BE CONTACTED PRIOR TO SEEDING TO COORDINATE OPERATIONS IN ORDER TO ENSURE FINAL ACCEPTANCE.
- ALL SEEDING OF DISTURBED AREAS MUST OCCUR IMMEDIATELY UPON COMPLETION OF THE GRADING WORK. WEATHER PERMITTING. SEEDING OPERATIONS SHOULD TAKE PLACE BETWEEN APRIL 15 AND JUNE 15 OR BETWEEN AUGUST 15 AND OCTOBER 30 AT THE LATEST. PROVIDING THE GROUND IS IN A FROST-FREE CONDITION. IN THE EVENT THAT IMMEDIATE COMPLETION OF

- SEEDING IS NOT FEASIBLE OTHER EROSION CONTROL METHODS WILL BE REQUIRED. DISCUSS WITH THE CONTRACT ADMINISTRATOR PRIOR TO PROCEEDING.
- HYDROSEED AFTER PLANTING IS COMPLETE. DO NOT APPLY HYDROSEED FROM A DISTANCE. BRING HOSE AND NOZZLE TO PLANTING AREA TO APPLY HYDROSEED DIRECTLY TO TOPSOIL AROUND PLANT MATERIAL. DO NOT DAMAGE PLANT MATERIAL WITH HOSE. HYDROSEED ALL EXPOSED TOPSOIL.
- ALL AREAS ON SLOPE DISTURBED DURING REMOVAL OF SEDIMENT AND EROSION CONTROL MEASURES ARE TO BE SEEDED WITH HYDROSEED APPLICATION OF THE SPECIFIED SEED MIX.
- ALL TOPSOIL COMPACTED ON SLOPE DURING CONSTRUCTION ACTIVITIES IS TO BE SCARIFIED TO THE SATISFACTION OF THE CONTRACT ADMINISTRATOR PRIOR TO SEED APPLICATION. IF DISTURBED AREA ON SLOPE EXTENDS BEYOND CONSTRUCTION LIMIT, APPLY 50mm THICK TOPSOIL AND SEED AS PER OPSS PROV 803.

**OSC SEED MIX #8340 LOW MAINTENANCE ECO LAWN**

Latin Name	Common Name	%
Festuca ovina	Hard Fescue	35%
Festuca rubra 'Communtata'	Chewings Fescue	35%
Festuca rubra	Creeping Red Fescue	20%
Lolium perenne	Perennial Ryegrass	10%

**Application:** Sow seed mix at rate of 25kg/ha. Seed common oats (Avena sativa) as a nurse crop at 22kg/ha in the spring. Seed fall ryegrass (Secale cereale) or winter wheat (Triticum aestivum) as a nurse crop and for erosion control at 22kg/ha in the fall.

**Available From:** Ontario Seed Company (OSC)  
 Address: 77 Wellington St. South, P.O. Box 7, Waterloo, ON N2J 3Z6 Phone: 519-886-0557 or 1-800-465-5849 Fax: 519-886-0605

**OSC SEED MIX #8135 NATIVE PRAIRIE MEADOW MIX**

Latin Name	Common Name	%
Aster novae-angliae	New England Aster	1%
Desmodium canadense	Showy Tick Trefol	1%
Monarda fistulosa	Wild Bergamot	2%
Panicum virgatum	Switchgrass	25%
Penstemon digitalis	Beardtongue	2%
Poa palustris	Fowl Bluegrass	25%
Rudbeckia hirta	Black Eyed Susan	7%
Schizachyrium scoparium	Little Bluestem	1%
Solidago juncea	Early Goldenrod	1%
Sorghastrum nutans	Indian Grass	20%
Verbena urticifolia	White Vervain	1%

**Application:** Sow seed mix at rate of 25kg/ha. Seed common oats (Avena sativa) as a nurse crop at 22kg/ha in the spring. Seed fall ryegrass (Secale cereale) or winter wheat (Triticum aestivum) as a nurse crop and for erosion control at 22kg/ha in the fall.

**Available From:** Ontario Seed Company (OSC)  
 Address: 77 Wellington St. South, P.O. Box 7, Waterloo, ON N2J 3Z6 Phone: 519-886-0557 or 1-800-465-5849 Fax: 519-886-0605

**REGISTRATION**



**ISSUE/REVISION**

IR	DATE	DESCRIPTION
6		
5	2023-04-28	ISSUED FOR PHASE 1 SPA
4	2023-03-02	ISSUED FOR CLIENT REVIEW
3	2023-02-10	ISSUED FOR CLIENT REVIEW
2	2022-12-20	ISSUED FOR PHASE 1 SPA
1	2022-10-26	ISSUED FOR DRAFT PLAN APPROVAL

**KEY PLAN**

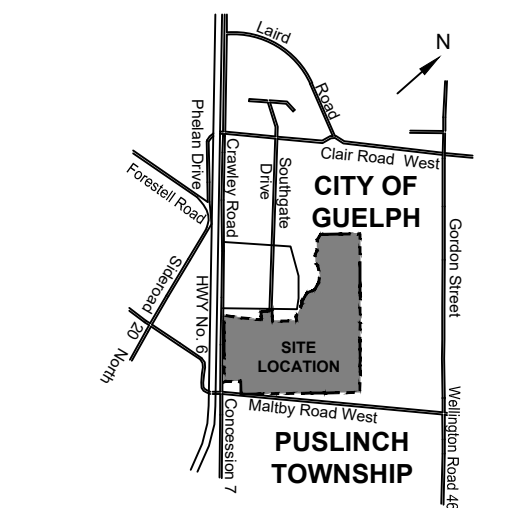

**PROJECT NUMBER**

60682143

**SHEET TITLE**

LANDSCAPE DETAILS & NOTES

**SHEET NUMBER**

L102

Last saved by: ASHLEY HOSKINER (2023-04-28) Last Printed: 2023-04-28 File name: \\NA.AECOM\NET\COMPLS\AMER\MARKHAM-CAT\T14\DCS\PROJECTS\BID\60682143\_NEWCOLD\900\_CAD\_GIS\911\_3\_PUBLISHED\60682143\_LAND\_SHT\_PHT1.DWG

This drawing has been prepared for the use of AECOM's client and may not be used, reproduced or relied upon by third parties, except as agreed by AECOM and its client, as required by law or for use by governmental reviewing agencies. AECOM accepts no responsibility, and denies any liability, whatsoever, to any party that modifies this drawing without AECOM's express written consent. Do not scale this document. All measurements must be obtained from stated dimensions.



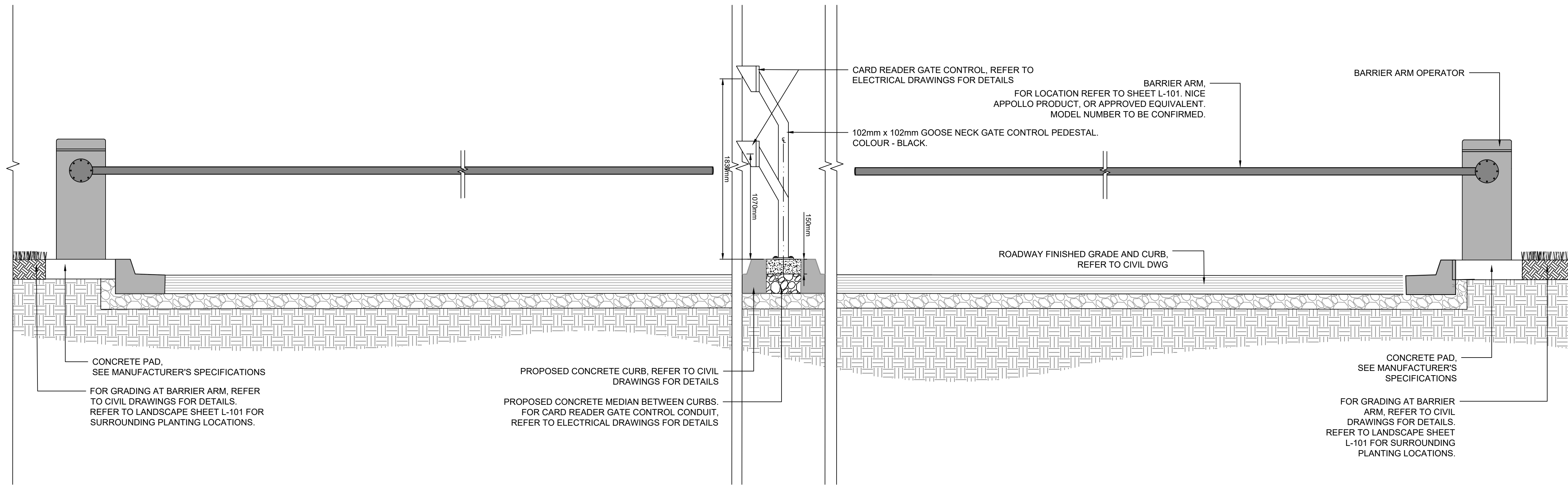

D1 BARRIER ARM LIFT GATE  
L104 1:25

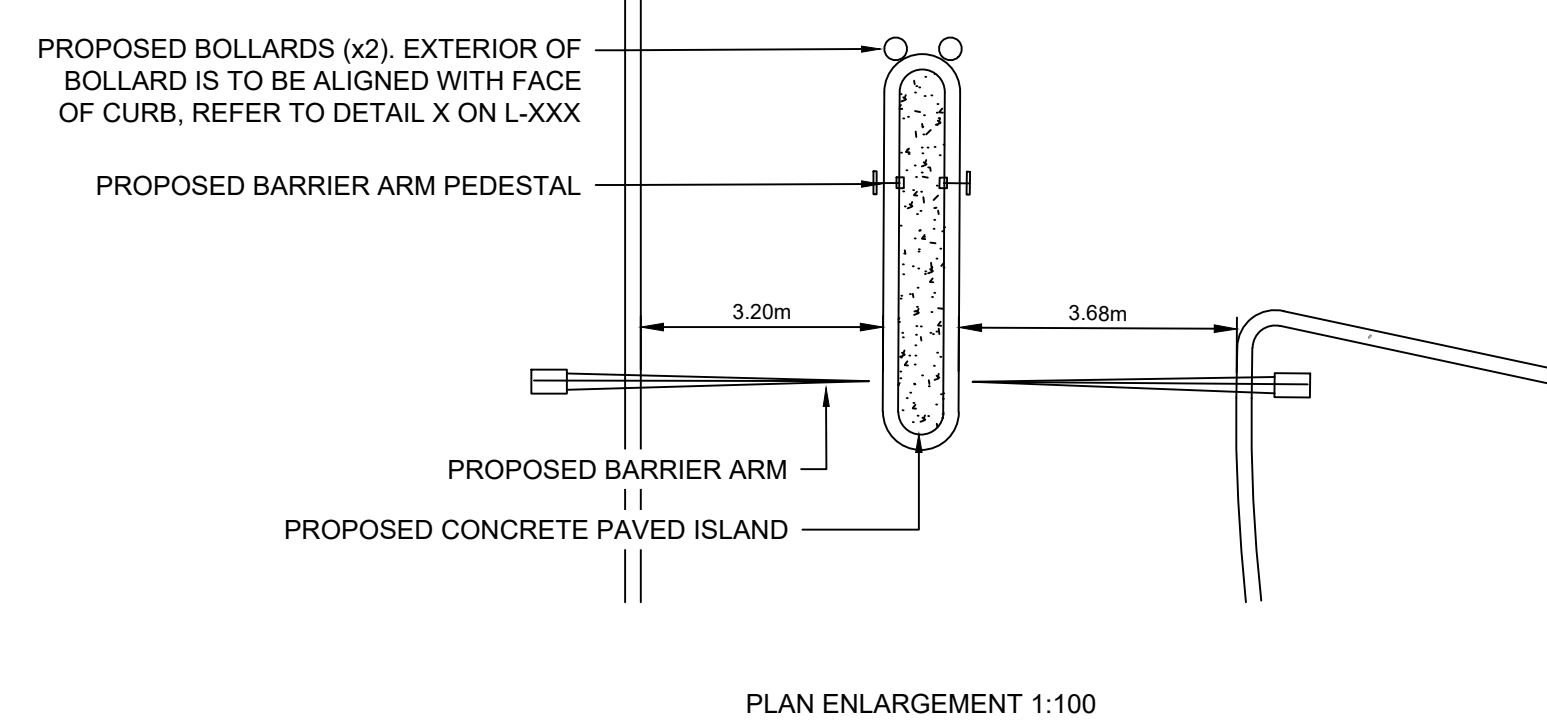

D2 BARRIER ARM LIFT GATE  
L104 1:100 DOUBLE TRUCK ENTRANCE FROM SOUTHGATE DRIVE SOUTH

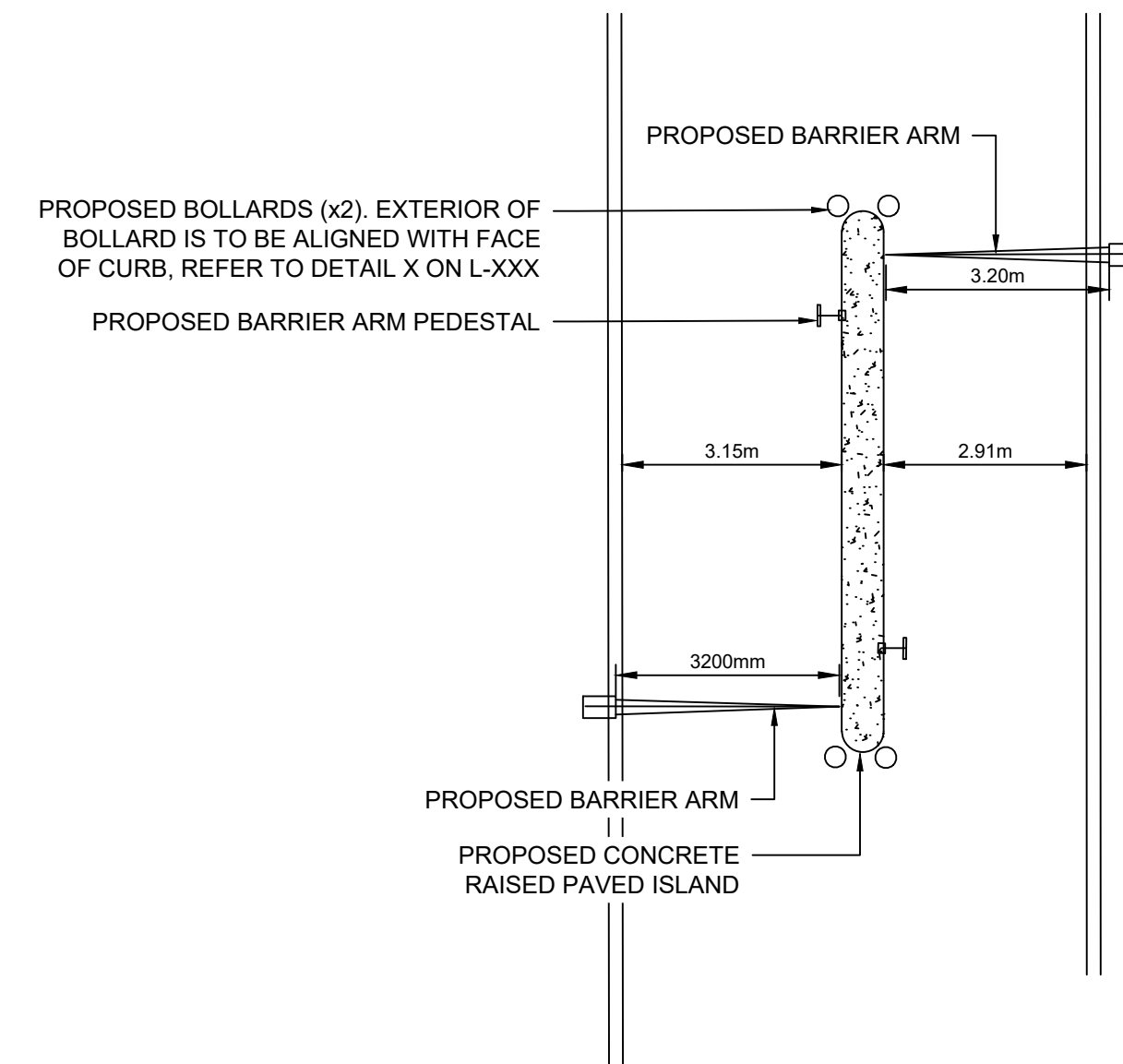

D3 BARRIER ARM LIFT GATE  
L104 1:100 VEHICULAR ENTRANCE FROM CRAWLEY ROAD

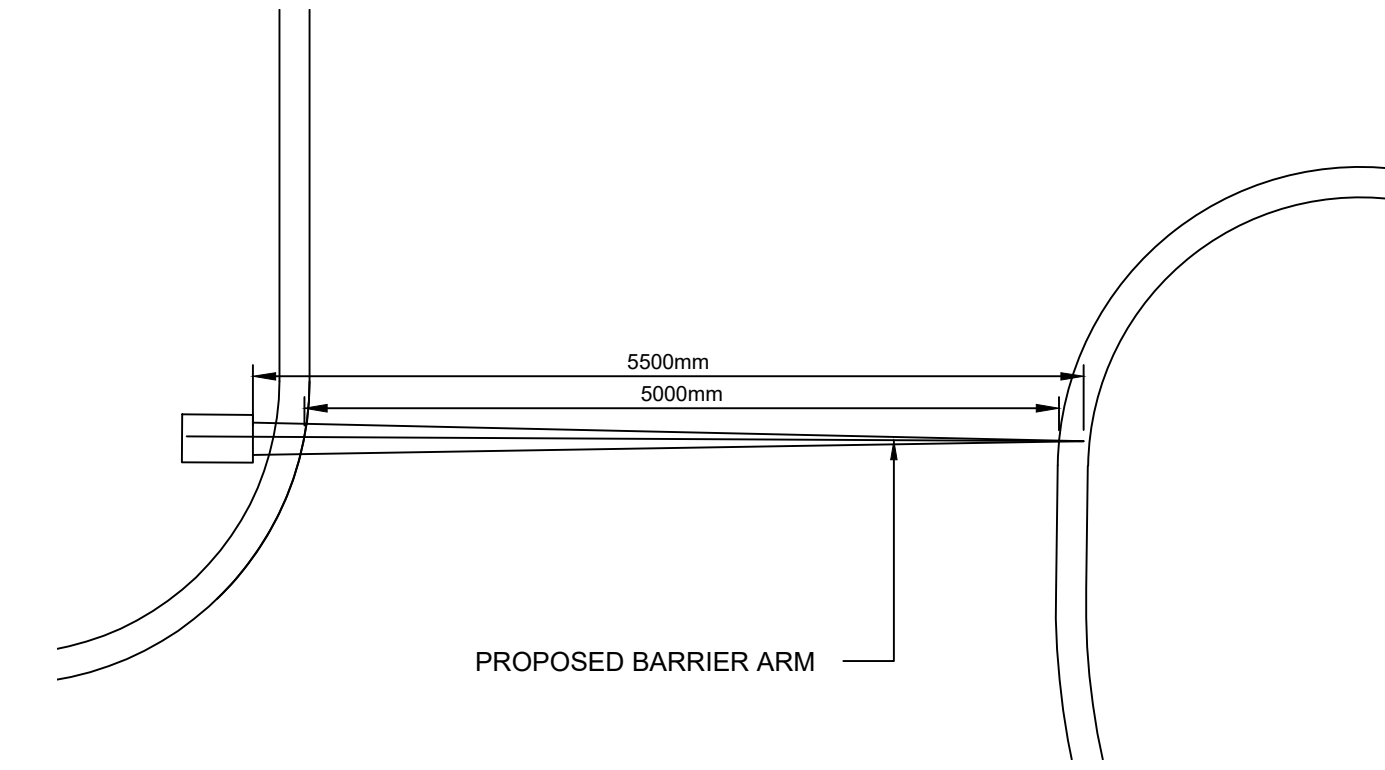

D4 BARRIER ARM LIFT GATE  
L104 1:100 INTERIOR TRUCK ENTRANCE

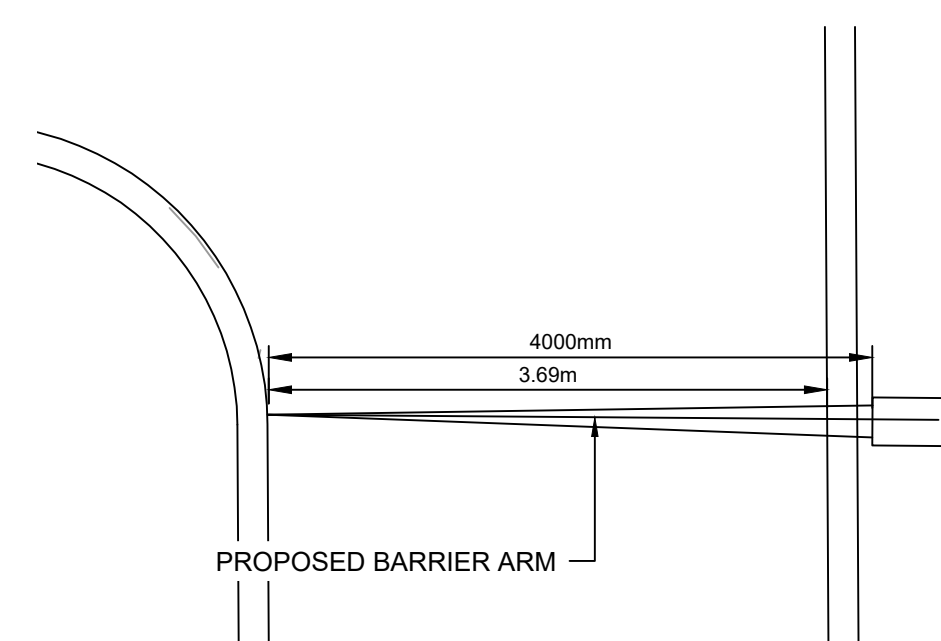

D5 BARRIER ARM LIFT GATE  
L104 1:100 INTERIOR TRUCK EXIT

4 M5BAR/L5BAR Models, AC with Solar Option Available

	M5BAR	M7BAR
Arm Length Max.	10 to 16 ft (3 to 5m)	16 to 23 ft (5 to 7m)
Field Adjustable Open/Close Time	3-6 seconds	6-10 seconds
Full Open Angle	Adjustable to 90 degrees (recommended to limit to 87 degrees)	
Ingress Protection	IP44	
Handling	Universal: field adaptable for left hand or right hand installations	
Arm Design	Aluminum arm with red adhesive reflector and optional lights/bumper strips	
Duty Cycle	350 cycles/hr	200 cycles/hr
Drive	Electromechanical	
Operating Voltage	24VDC	
Input Voltage	120VAC 60/50Hz	
Idle Current	1.1mA	1.1mA
Temperature Rating	-4 to 122 F (-20 to 50 C)	
Communication	Optional Oview programmer, OVBT	
User Controls	BCU1 Control Board	
Relays	4 programmable voltage outputs	
Finish	Cataphoretic coating and paint finish	
ETL Listed (UL 325)	Usage Class I, II, III, IV	
Cycle Tested	1 million cycles	
Warranty	2 years	



I/R	DATE	DESCRIPTION
6		
5		
4		
3	2023-04-28	ISSUED FOR PHASE 1 SPA
2	2023-03-02	ISSUED FOR CLIENT REVIEW
1	2023-02-10	ISSUED FOR CLIENT REVIEW

