

# 59 Division Street, Guelph, Ontario



## Site Map Location

**NOTE:**  
Scope of Work is for the Renovation of the Existing Apartment Unit and Ground Floor Garage Addition. No changes to the Existing Ground Floor Commercial Unit or Grading.

**LEGEND:**

- Property Line
- Asphalt Parking
- Required Parking Space
- Existing Public Entrance Door
- 2nd Floor Accessory Apartment Unit Entrance

**LEGEND:**  
R = RETAIL PARKING  
A = APARTMENT PARKING

EXISTING LOT AREA = 6,527.1sq.ft. (605.46sq.m)  
EXISTING BUILDING FOOTPRINT = 1,310.2sq.ft. (121.72sq.m)  
EXISTING GARAGE(TO BE DEMOD') = 283.1sq.ft. (26.3sq.m)  
PROPOSED ADDITION = 504.87sq.ft.(46.89sq.m)  
LOT COVERAGE RATIO = 27.8%

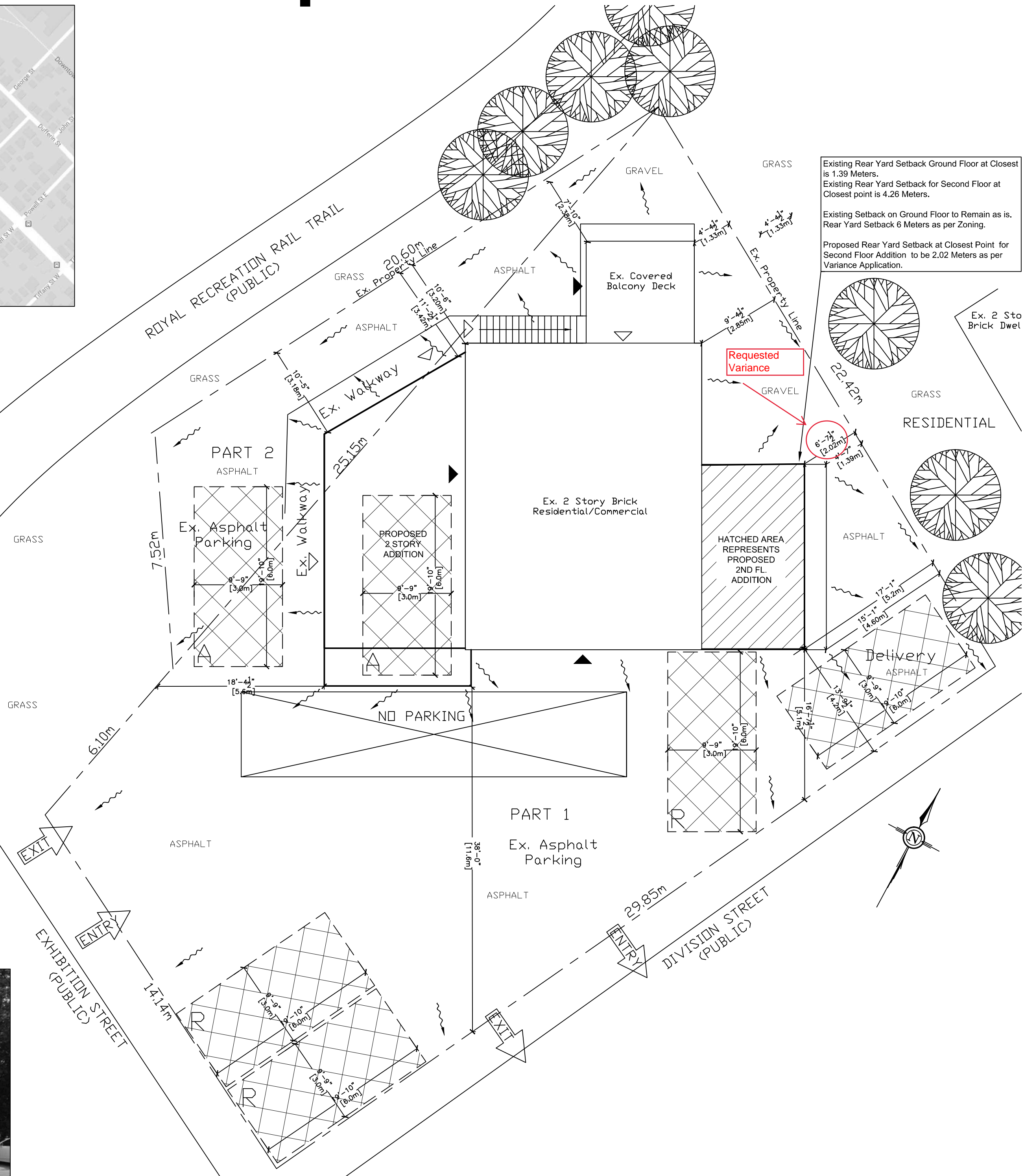

Existing Site Plan w/PROPOSED ADDITION  
SCALE 1:100

## Proposed Addition and Renovation

**notes:**  
NO WORK TO PROCEED PRIOR TO OBTAINING BUILDING PERMIT.  
CONTRACTOR WILL CHECK AND VERIFY ALL DIMENSIONS & CHECK ALL CONDITIONS ON THE JOB BEFORE PROCEEDING WITH WORK.  
ALL DISCREPANCIES TO BE REPORTED TO THE OWNER.  
ALL EXTERIOR AND INTERIOR FINISHES AND COLOURS ARE TO BE APPROVED BY THE OWNER.

drawing revision history:

revision issued for	rev no.	date	by

project info:  
59 DIVISION STREET  
GUELPH, ONT.  
N1H 1R1

sheet title:  
SITE PLAN & SITE DATA

date: DECEMBER 1st, 2022	designed by: JB
scale: 1: 200	checked by: AR
project no: 2022-24	drawing no: S1 (1 of 13)