

PROPOSED SIDE
ENTRANCE

588 STARWOOD DRIVE
GUELPH
ONTARIO
N1E 0L9

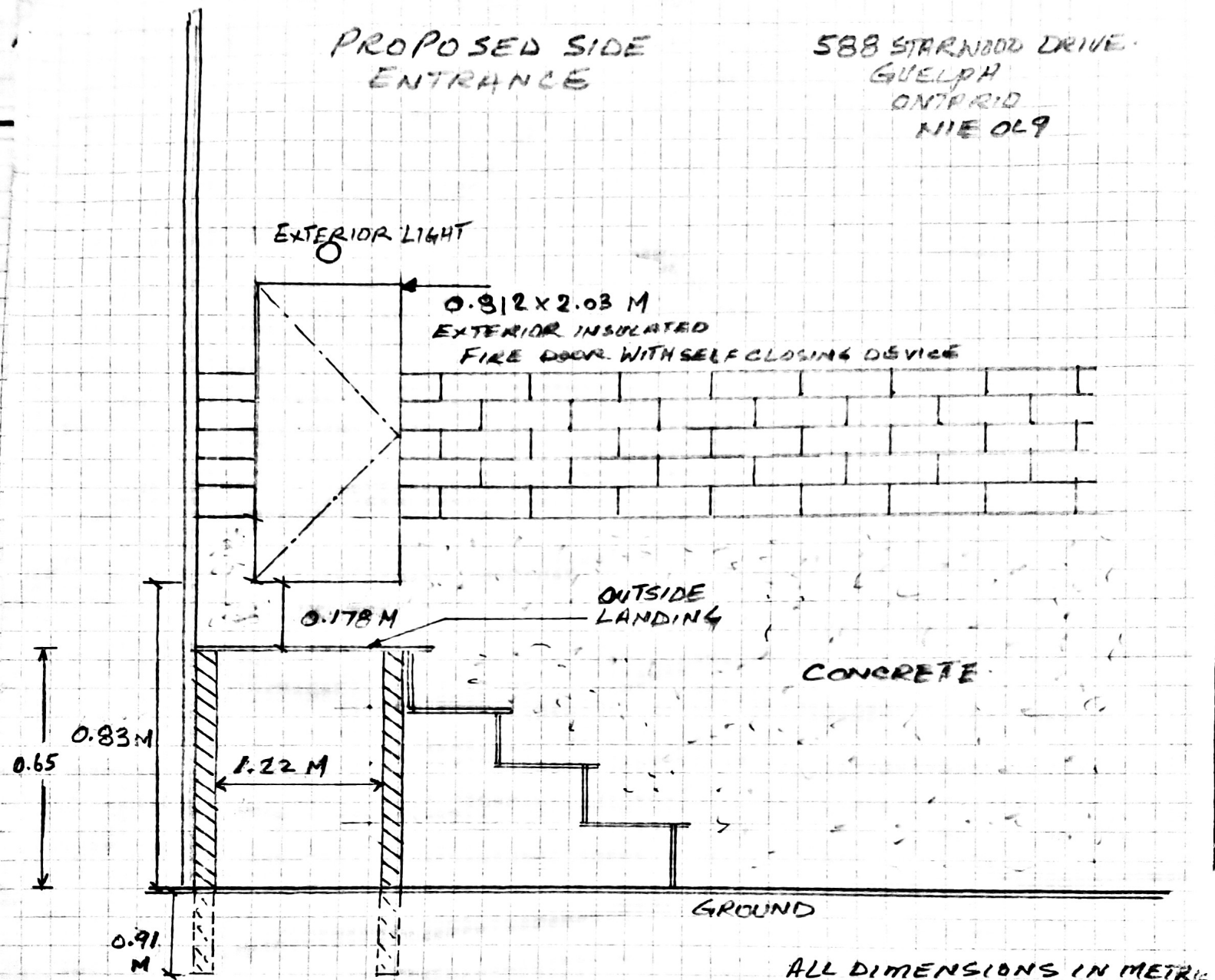

ALL DIMENSIONS IN METRIC

NOTES:

- ① OUTSIDE LANDING
0.64 x 0.64
- ② STAIRS
RISE 2.01
TREAD 3.04
- ③ OUTSIDE LANDING & STAIRS.
WOODEN STRUCTURE
MATERIAL - PRESSURE TREATED
- ④ HAND RAIL
(NOT SHOWN)
TO BE ON 2 SIDES OF LANDING
& ALONG STAIRS.
TO BE 70.66 HIGH
- ⑤ LANDING TO BE BUILT ON
4 - 4" x 4" PRESSURE TREATED
WOOD.